

MULTI - PORT PCB JACK

YIMTEX .

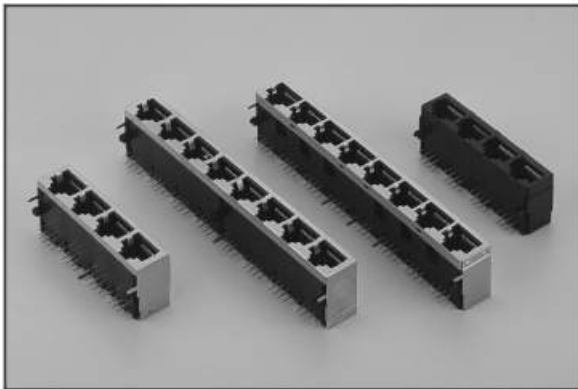

MATERIAL

Shielded: 0.25mm Thickness Copper Alloy With Tin Plated
 Housing : Standard Material Glass Filled Polyester (UL94V-0)
 Standard Color Black
 Contact : 0.35mm Thickness Alloy C5210, Gold Plating Over
 Nickel in Contact Area.
 Tin Plating Over Nickel in Solder Area.

METAL SHELL

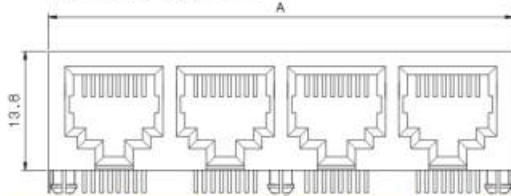

ALL PLASTIC

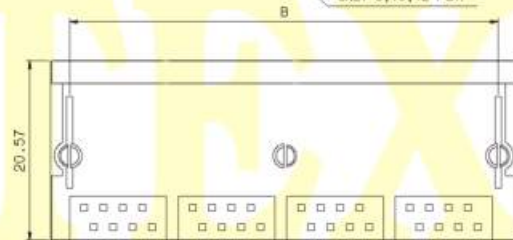
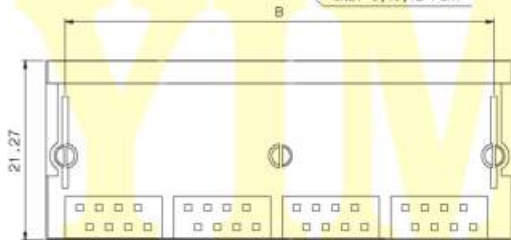
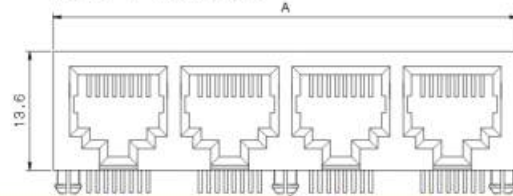

POSITION	A	B	C
2	31.12	25.40	30.87
4	59.03	53.34	58.81
5	73.03	67.31	72.78
6	87.00	81.28	86.75
8	114.94	109.22	114.69
10	142.88	137.16	142.63
12	170.82	165.10	170.57

POSITION	A	B	C
2	30.48	25.40	13.97
4	58.42	53.34	41.91
5	72.39	67.31	55.88
6	86.36	81.28	69.85
8	114.30	109.22	97.79
10	142.24	137.16	125.73
12	170.18	165.10	153.67

P.C.B. LAYOUT

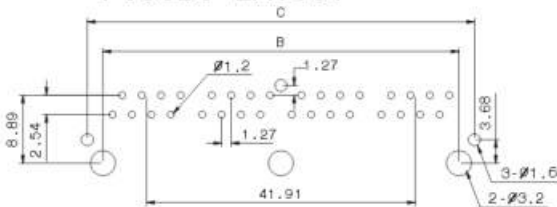

P.C.B. LAYOUT

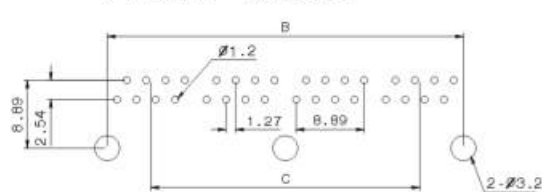

ORDER INFORMATION:

Series No.	Pins	No of Ports	Contact Plating
243A	8P8C	02	S
All Plastic	8P8C	02	S: Selective Gold
		04	S1: 5u" Selective Gold
		05	S2: 15u" Selective Gold
		06	S3: 30u" Selective Gold
		08	
		10	
		12	

Series No.	Pins	No of Ports	Contact Plating
243M	8P8C	02	S
Metal Shell	8P8C	02	S: Selective Gold
		04	S1: 5u" Selective Gold
		05	S2: 15u" Selective Gold
		06	S3: 30u" Selective Gold
		08	
		10	
		12	