

Recommended PCB Layout
 General Tolerance: ± 0.05
 ▨ Solder Area

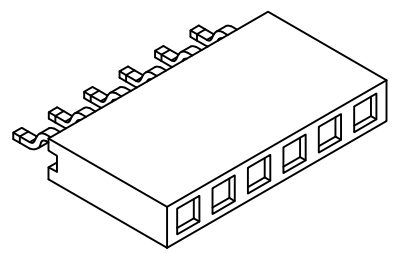

Number of Contacts	Dimensions	
	A	B
2	5.63	2.54
3	8.17	5.08
4	10.71	7.62
5	13.25	10.16
6	15.79	12.70

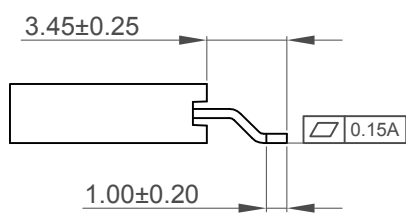
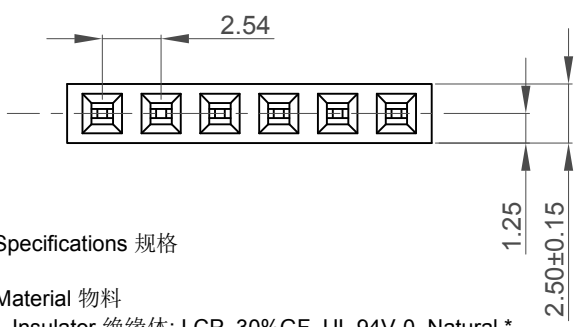

Specifications 规格

Material 物料

Insulator 绝缘体: LCP, 30%GF, UL 94V-0, Natural *
 Contact 接触: Copper Alloy

Plating 电镀

Underplating 底层电镀: 50 μ "-100 μ " Nickel all over
 Contact Area 接触部分: See ordering grid

Electrical 电气

Current Rating 电流额定值: 3A per pin
 Contact Resistance 接触电阻值: 20 m Ω max.
 Insulating Resistance 绝缘电阻值: 1000 M Ω min.
 Dielectric Withstand Voltage 耐电压: 500V AC

Mechanical & Environmental 机械 & 环境

Operating Temperature 工作温度: -40°C to +105°C
 Mating Force 插入力: 35N (3.57Kgf) max.
 Unmating Force 拨出力: 10N (1.02Kgf) min.
 Durability 耐久性: 1,500 Cycles

Soldering Process 可焊性:

IR Reflow 回流焊: 260°C for 10 secs
 Manual Solder 人工焊接: 350°C for 3-5 secs

Mates with 配套之公头:

BG301 for perfect horizontal mating.
 (max. mating pin length 5.4mm)

*Standard black insulator version of BG300 is BG230

Ordering Grid

BG300 - **XX** - **X** - **L** - **A** Request Samples and Quotation

No. of Contacts: 02 to 06

Contact Plating: A = Gold Flash All Over
 (Other plating options available on request)

Packing: A = Tape and Reel (MOQ 1400pcs)

Insulator Material: L = LCP (Natural)

Part Number		Product Description	
BG300		2.54mm Pitch Socket	
Drawing Date		Single Row, Surface Mount, Horizontal, Natural LCP	
7th December 2011			
By	CC	Tolerances (Except as Noted)	Units:
Detail	BG300 C PCN	Length X.X \pm 0.30 X.XX \pm 0.25	Metric (mm)
Revision	C1	Angle	
Date	30/11/16		



This drawing is confidential and copyright of Global Connector Technology, Ltd (GCT). This drawing must not be copied or disclosed without written consent. E & OE



Not to Scale	Drawn By CM	Sheet No. 1/2
--------------	----------------	------------------

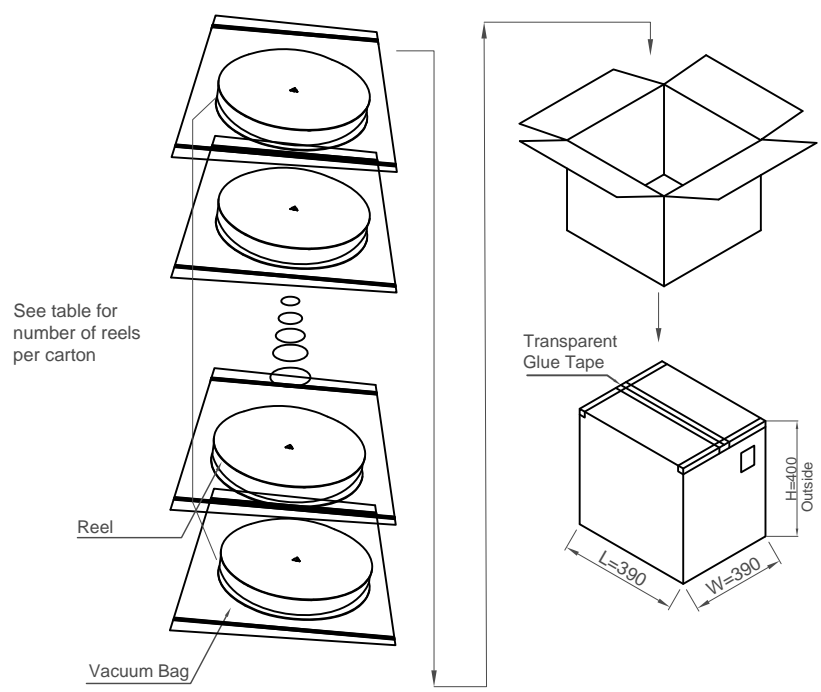
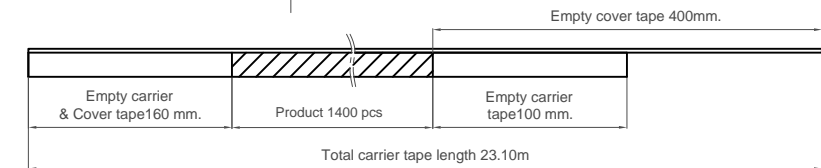
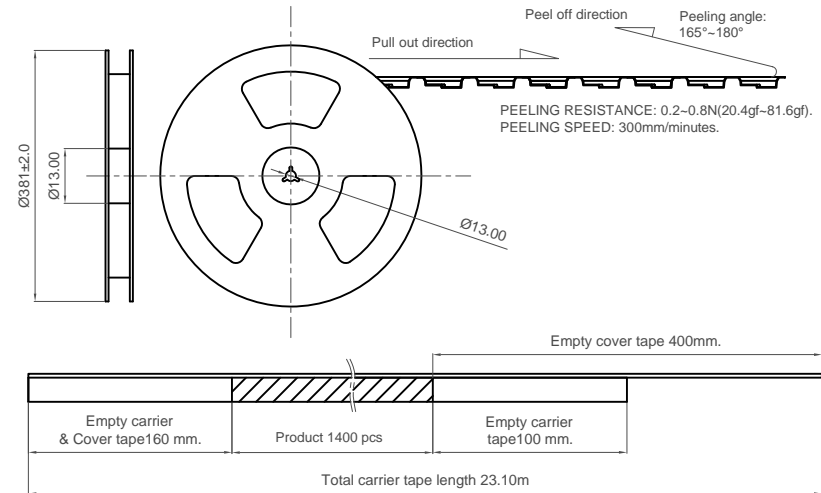
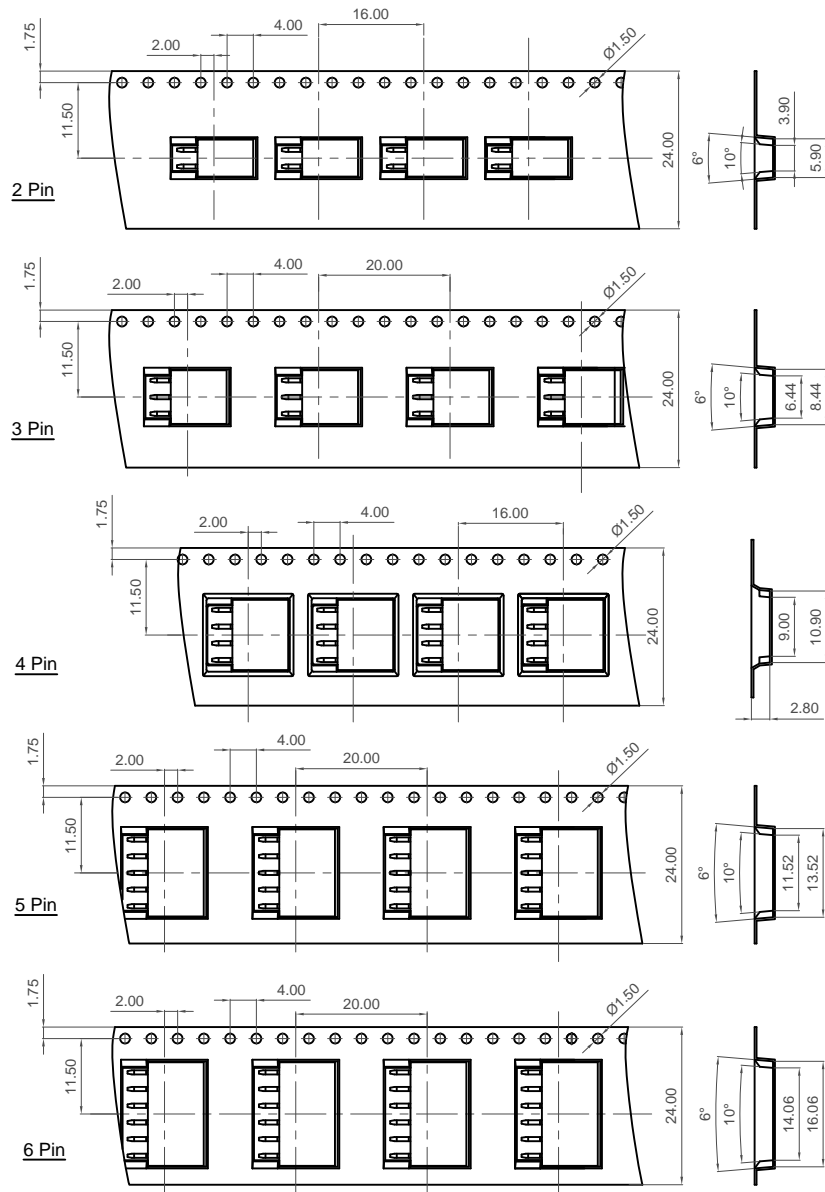

No. of Contacts	Units/ Reel	Reels/ Carton	Units/ Carton	Total Carrier Tape Length
2 & 3	1,400 pcs	16	22,400	23.1 m
4, 5 & 6	1,400 pcs	10	14,000	23.1 m

Part Number		Product Description	
BG300		2.54mm Pitch Socket	
Drawing Date		Single Row, Surface Mount, Horizontal, Natural LCP	
7th December 2011			
By	CC	Tolerances (Except as Noted)	Units:
Detail	BG300	Length	Metric (mm)
	C PCN	Angle	
Revision	C1		
Date	30/11/16		

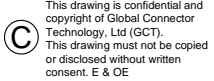

GCT
Global Connector Technology
www.gct.co

Not to Scale	Drawn By CM	Sheet No. 2/2
--------------	----------------	------------------

H
G
F
E
D
C
B
A

1 2 3 4 5 6 7 8