

Global Connector Technology Ltd. - FFC2A30 : FPC 0.5mm Pitch Top Entry, Left or Right Footprint, SMT, Height=4.4mm, ZIF, Slide Type

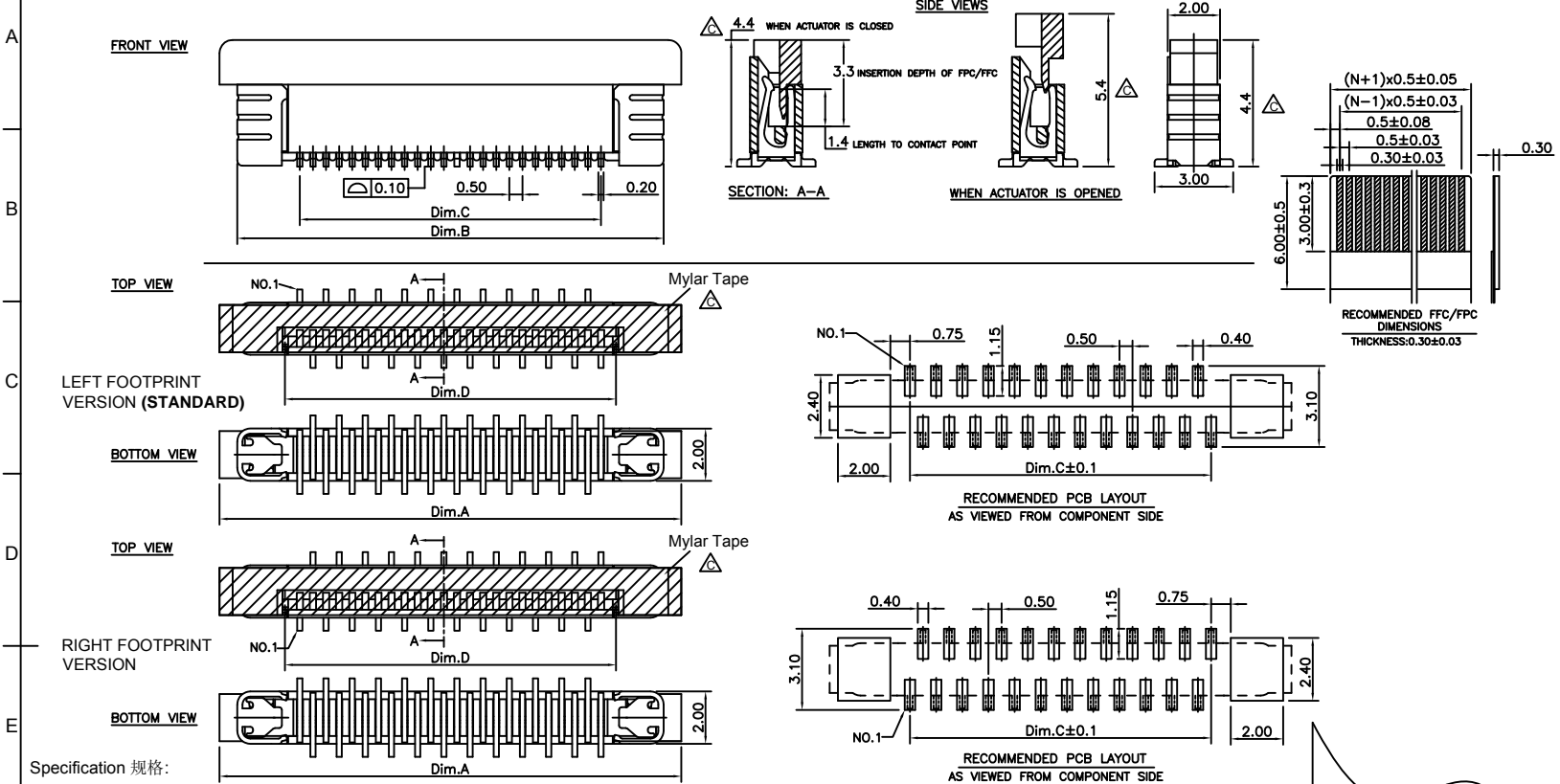

Pin No.	Dim.A	Dim.B	Dim.C	Dim.D
* 4	7.6	6.5	1.50	2.60
* 5	8.1	7.0	2.00	3.10
* 6	8.6	7.5	2.50	3.60
* 7	9.1	8.0	3.00	4.10
* 8	9.6	8.5	3.50	4.60
* 9	10.1	9.0	4.00	5.10
* 10	10.6	9.5	4.50	5.60
* 11	11.1	10.0	5.00	6.10
* 12	11.6	10.5	5.50	6.60
* 13	12.1	11.0	6.00	7.10
* 14	12.6	11.5	6.50	7.60
* 15	13.1	12.0	7.00	8.10
* 16	13.6	12.5	7.50	8.60
* 17	14.1	13.0	8.00	9.10
* 18	14.6	13.5	8.50	9.60
* 19	15.1	14.0	9.00	10.10
* 20	15.6	14.5	9.50	10.60
* 21	16.1	15.0	10.00	11.10
* 22	16.6	15.5	10.50	11.60
* 23	17.1	16.0	11.00	12.10
* 24	17.6	16.5	11.50	12.60
* 25	18.1	17.0	12.00	13.10
* 26	18.6	17.5	12.50	13.60
* 27	19.1	18.0	13.00	14.10
* 28	19.6	18.5	13.50	14.60
* 29	20.1	19.0	14.00	15.10
* 30	20.6	19.5	14.50	15.60
* 31	21.1	20.0	15.00	16.10
* 32	21.6	20.5	15.50	16.60
* 33	22.1	21.0	16.00	17.10
* 34	22.6	21.5	16.50	17.60
* 35	23.1	22.0	17.00	18.10
* 36	23.6	22.5	17.50	18.60
* 37	24.1	23.0	18.00	19.10
* 38	24.6	23.5	18.50	19.60
* 39	25.1	24.0	19.00	20.10
* 40	25.6	24.5	19.50	20.60
* 41	26.1	25.0	20.00	21.10
* 42	26.6	25.5	20.50	21.60
* 43	27.1	26.0	21.00	22.10
* 44	27.6	26.5	21.50	22.60
* 45	28.1	27.0	22.00	23.10
* 46	28.6	27.5	22.50	23.60

* = Tooled Parts
 Please contact GCT for non-tooled parts
 Non-tooled MOQ 10k pcs

Specification 规格:

Material 物料规格:

Housing Material: High-Temp Plastic LCP (UL 94V-0), White 塑胶外壳
 Actuator: LCP (UL 94V-0), Black
 Contact: Phosphor Bronze 磷青铜
 Finish (a) Contact Plating: see ordering grid
 (b) Underplating: Nickel-plated all over
 Fitting Nail: Brass, tin plated 黄铜, 镀锡

Mechanical
 Durability: 20 Cycles

Electrical 电气规格:

Voltage Rating (Max.): 50V AC/DC 最大额定电压 50V AC/DC
 Current Rating (Max.): 0.4A AC/DC 最大额定电流 0.4A AC/DC
 Dielectric Strength: 250V AC for 1 minute between adjacent terminal, no breakdown
 电介质强度: 250V AC于相邻端子, 1分钟, 无损害
 Insulation Resistance: 50 MΩ Min. 250V DC for 1 minute between adjacent terminal
 绝缘阻抗: 50MΩ, 250V DC 于相邻端子1分钟
 Contact Resistance: 40 mΩ Max. 连接阻抗: 40 毫欧
 Operating Temperature: -25°C to +85°C 工作温度: -25° to +85°
 Solder Profile: Peak Temp 260°C (+0/-5°C) Maximum (5 seconds)



No. of Contacts
 04 - 46
 (see dimension table)

Contact Footprint
 L=Left (Standard)
 R=Right

Contact Plating
 T=Tin Plating over all (Standard) - reel qty=1000pcs
 G=Gold Flash over all - reel qty=1000pcs, MOQ 5 reels

By	PKN	SA	SA
DETAIL	DRAWING RELEASE	ECN: FFC2A30-001	ECN: FFC2A30-002
REV DATE	A 24/05/10	B 01/04/11	C 15/08/11



Tolerances (Except as noted)	Part Number:-	Date:-
Dimensions in mm X.X ± 0.30 X.X ± 2° X.XX ± 0.15 X.XX ± 1° X.XXX ± 0.10 X.XXX ± 0.5°	FFC2A30	24 MAY 10
Third Angle Projection	Description:- FPC 0.5mm PITCH TOP ENTRY, LEFT OR RIGHT FOOTPRINT, SMT, HEIGHT=4.4mm, ZIF, SLIDE TYPE	
	THIS DRAWING IS CONFIDENTIAL AND MUST NOT BE COPIED OR DISCLOSED WITHOUT WRITTEN CONSENT	

GCT

www.globalconnectortechonlogy.com

Scale NTS	Revision C	Material See Note	Drawn by PKN	E & OE	Sheet No. 1/2
-----------	------------	-------------------	--------------	--------	---------------

Pin No.	Dim.A	Dim.B	Dim.C	Dim.D
4	7.6	8.1	16	16.5
5	8.1	8.6		
6	8.6	9.1		
7	9.1	9.6		
8	9.6	10.1	24	24.5
9	10.1	10.6		
10	10.6	11.1		
11	11.1	11.6		
12	11.6	12.1		
13	12.1	12.6		
14	12.6	13.1		
15	13.1	13.6		
16	13.6	14.1	32	32.5
17	14.1	14.6		
18	14.6	15.1		
19	15.1	15.6		
20	15.6	16.1		
21	16.1	16.6		
22	16.6	17.1		
23	17.1	17.6		
24	17.6	18.1		
25	18.1	18.6		
26	18.6	19.1	44	44.5
27	19.1	19.6		
28	19.6	20.1		
29	20.1	20.6		
30	20.6	21.1		
31	21.1	21.6		
32	21.6	22.1		
33	22.1	22.6		
34	22.6	23.1		
35	23.1	23.6		
36	23.6	24.1		
37	24.1	24.6		
38	24.6	25.1		
39	25.1	25.6		
40	25.6	26.1		
41	26.1	26.6		
42	26.6	27.1		
43	27.1	27.6		
44	27.6	28.1		
45	28.1	28.6		
46	28.6	29.1		

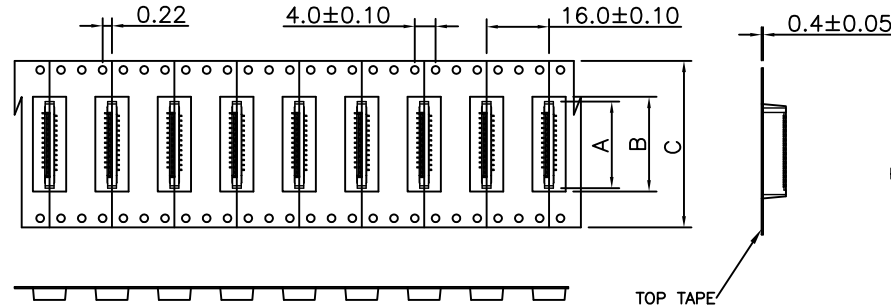
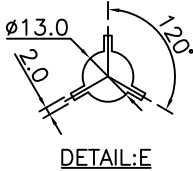
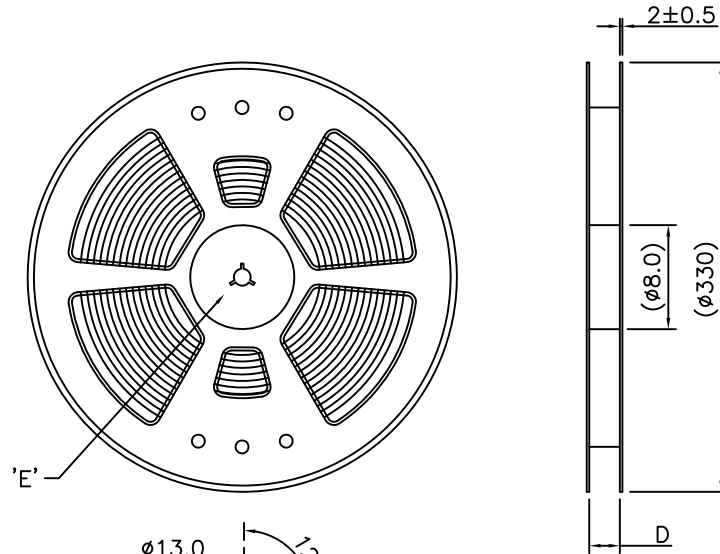

NOTES:

1.Number of Connectors:

1000 Pcs/Reel

2.Material

Carrier Tape:PET,PE,PEF

Reel:PS

3.Lead Tape Length:

PULL OUT DIRECTION

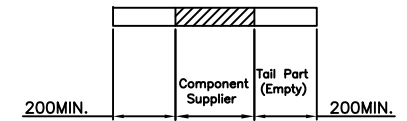

4.Peeling off force of top tape

0.5N~1.2N(51.0gf~122.4gf)

(Peeling direction as shown in following fig)

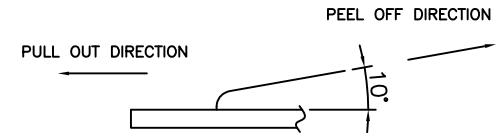

By	PKN	SA	SA
DETAIL	DRAWING	ECN:	ECN:
RELEASE	FFC2A30-001	FFC2A30-002	
REV	A	B	C
DATE	24/05/10	01/04/11	15/08/11

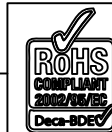
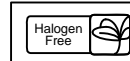

Tolerances (Except as noted)	Part Number:-	Date:-
Dimensions in mm	FFC2A30	24 MAY 10
X.X ± 0.30	X.X ± 2°	Description:- FPC 0.5mm PITCH TOP ENTRY, LEFT OR RIGHT FOOTPRINT, SMT, HEIGHT=4.4mm, ZIF, SLIDE TYPE
X.XX ± 0.20	X.XX ± 1°	
X.XXX ± 0.05	X.XXX ± 0.5°	
Third Angle Projection	© THIS DRAWING IS CONFIDENTIAL AND MUST NOT BE COPIED OR DISCLOSED WITHOUT WRITTEN CONSENT	

GCT

www.globalconnectortechonology.com

Scale	Revision	Material	Drawn by	Sheet No.
NTS	C	See Note	PKN	E & OE
				2/2