

Dynamic Receiver



Dynamic Receiver

Speedy Reference List

Part Number	Page
Piezoelectric Telephone Receiver	
KPEG006	D-03
Round Type	
KDRG057016A	D-03
KDRG09016A-4	D-04
KDRG14818A-2	D-04
KDRG18032	D-05
KDRG30032A	D-05
KDRG40016C	D-06
KDRG40016D	D-06
Square Type	
KDRG0612C-008	D-07
KDRG1506Q-32PF1	D-07
Waterproof Type	
KDRG0612Q-32P	D-08

Dynamic Receiver Coding System

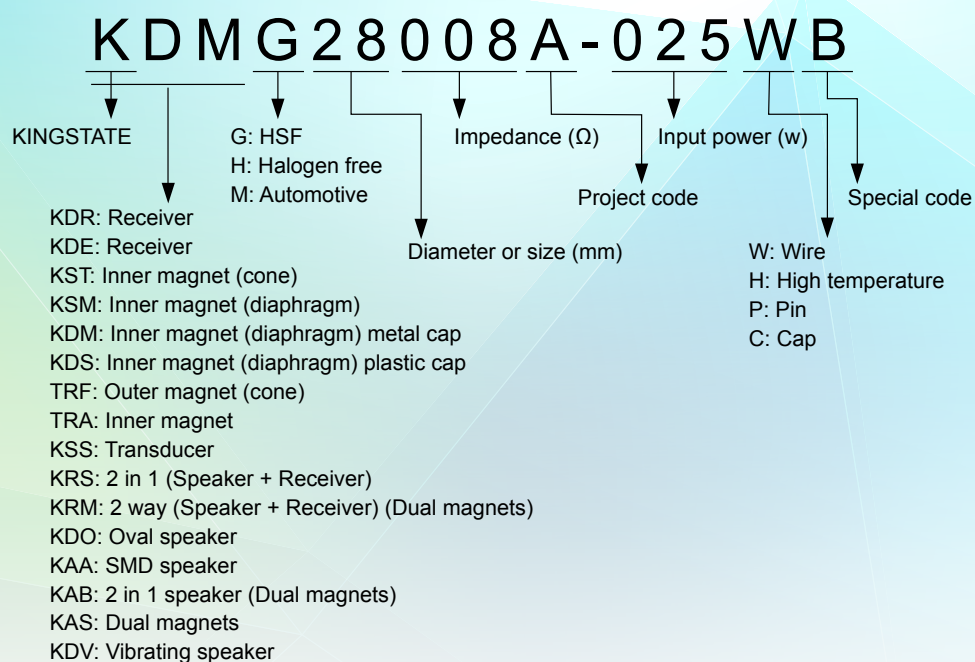

Piezoelectric Telephone Receiver

KPEG006



Dimension

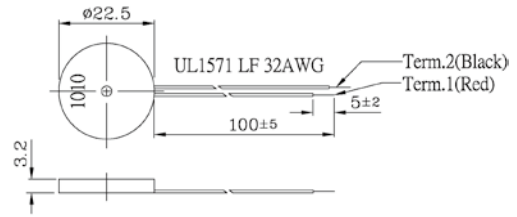

Tol: ± 0.5 Unit: mm

Electrostatic capacity (PF)	90,000 ± 30% @ 120Hz/0.25V
Sound Pressure Level (dB)	108 ± 3 @ 1.0KHz 1.0V with IEC318 Coupler
Impedance (Ω)	2.0K ± 25% @ 1.0KHz
Frequency Range (Hz)	400 ~ 4K
Operating Temperature (°C)	-30 ~ +85
Dimension (mm)	Φ22.5x H3.2
Material	ABS UL-94 1/16" HB High Heat (Black)

Characteristic

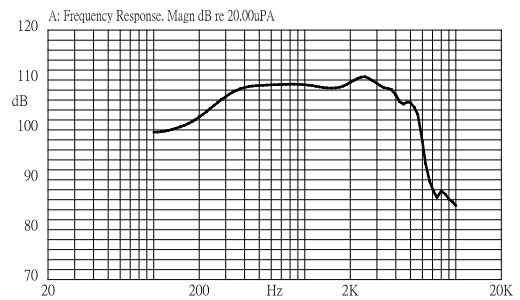

Round Type

Dynamic Receiver

KDRG057016A



Dimension

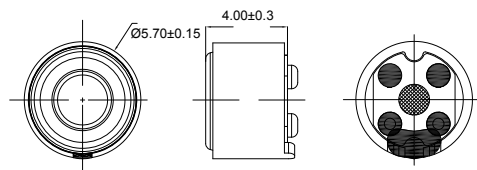

Tol: ± 0.5 Unit: mm

Rated Power (mW)	3.0
Max. Input Power (mW)	5.0
Sound Pressure Level (dB)	92.7 ± 3 @ 1.0KHz 126mV with IEC318 Coupler
Impedance (Ω)	16 ± 15% @ 1.5KHz
Frequency Range (Hz)	100 ~ 10K
Operating Temperature (°C)	-20 ~ +55
Dimension (mm)	Φ5.7xH4.0
Material	Metal

Characteristic

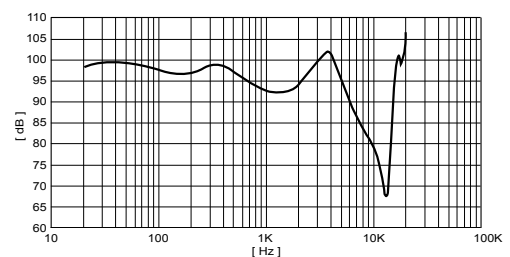

Round Type

Dynamic Receiver

KDRG09016A-4

Dimension

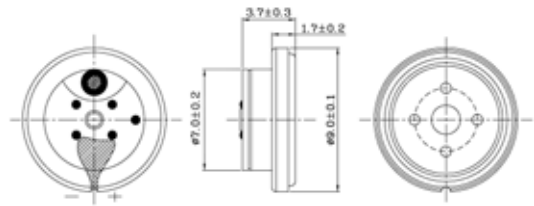

Tol: ± 0.5 Unit: mm

Rated Power (mW)	5
Max. Input Power (mW)	50
Sound Pressure Level (dB)	93 ± 3dB@1.0KHz 126mV with IEC318 Coupler
Impedance (Ω)	16 ± 15%@1.5KHz
Frequency Range (Hz)	100 ~ 10K
Operating Temperature (°C)	-20 ~ +55
Dimension (mm)	Φ9.0xH3.7
Material	Metal

Characteristic

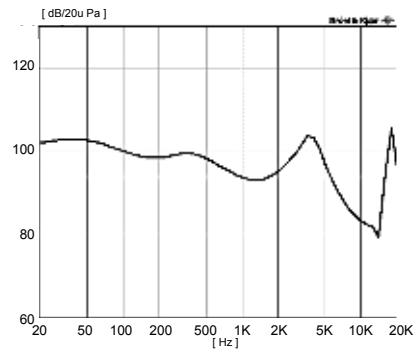

Round Type

Dynamic Receiver

KDRG14818A-2

Dimension

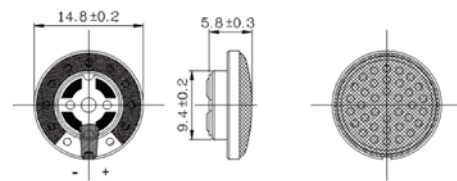

Tol: ± 0.5 Unit: mm

Rated Power (mW)	1
Max. Input Power (mW)	3
Sound Pressure Level (dB)	117 ± 3@1.0KHz 130mV rms
Impedance (Ω)	18 ± 15%@1.0KHz
Frequency Range (Hz)	20 ~ 20K
Operating Temperature (°C)	-20 ~ +55
Storage Temperature (°C)	-20 ~ +55
Dimension (mm)	Φ14.8xH5.8
Material	Metal

Characteristic

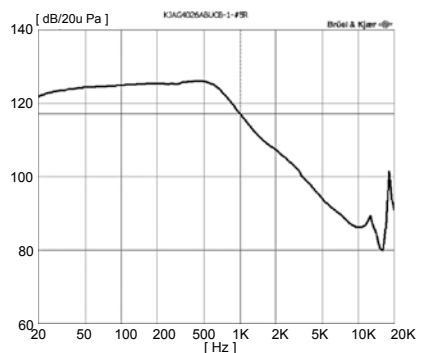

Round Type

Dynamic Receiver

KDRG18032

Dimension

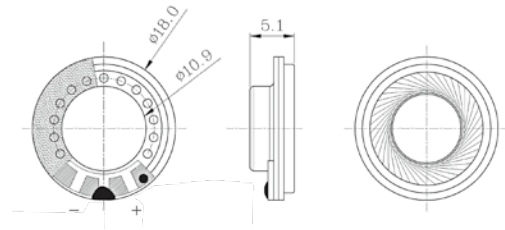

Tol: ± 0.5 Unit: mm

Rated Power (mW)	12
Max. Input Power (mW)	15
Sound Pressure Level (dB)	119 ± 3@1.0KHz 179mV with IEC318 Coupler
Impedance (Ω)	32 ± 15%@1.5KHz
Frequency Range (Hz)	100 ~ 10K
Operating Temperature (°C)	-20 ~ +55
Dimension (mm)	Φ18.0xH5.1
Material	Metal

Characteristic

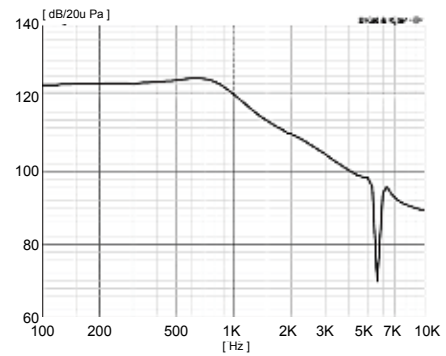

Round Type

Dynamic Receiver

KDRG30032A

Dimension

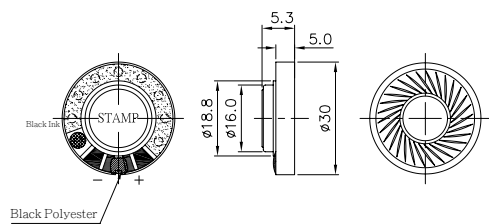

Tol: ± 0.5 Unit: mm

Rated Power (mW)	5
Max. Input Power (mW)	10
Sound Pressure Level (dB)	116 ± 3@1.0KHz 179mV with IEC318 Coupler
Impedance (Ω)	32 ± 15%@1.0KHz, 1.0V
Frequency Range (Hz)	200 ~ 20K
Operating Temperature (°C)	-20 ~ +55
Storage Temperature (°C)	-20 ~ +55
Dimension (mm)	Φ30.0xH5.3
Material	ABS (Black)

Characteristic

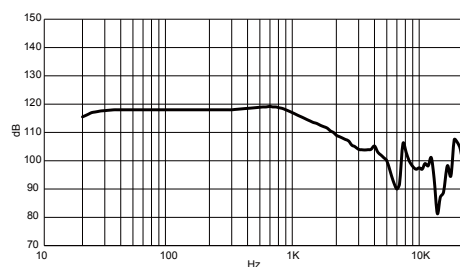

Round Type

Dynamic Receiver

KDRG40016C



Dimension

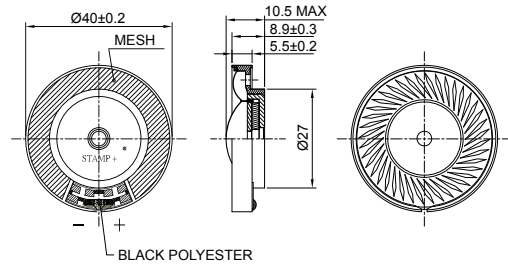

Tol: ± 0.5 Unit: mm

Rated Power (mW)	20
Max. Input Power (mW)	40
Sound Pressure Level (dB)	123 ± 3@1.0KHz 565mV with IEC318 Coupler
Impedance (Ω)	16 ± 15%@1.5KHz,1.0V
Frequency Range (Hz)	85 ~ 8K
Operating Temperature (°C)	-25 ~ +50
Dimension (mm)	Φ40.0xH8.9
Material	Metal

Characteristic

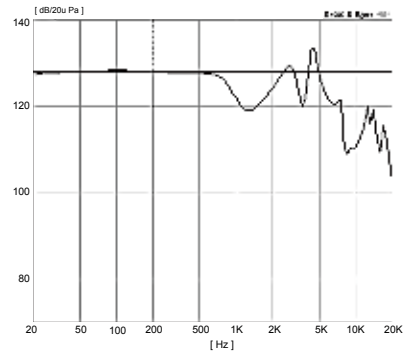

D Dynamic Receiver

Round Type

Dynamic Receiver

KDRG40016D



Dimension

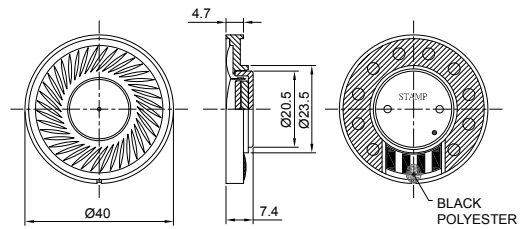

Tol: ± 0.5 Unit: mm

Rated Power (mW)	20
Max. Input Power (mW)	40
Sound Pressure Level (dB)	122 ± 3@1.0KHz,179mV,IEC318 coupler
Impedance (Ω)	16 ± 15%@1.5KHz,1.0V
Frequency Range (Hz)	20 ~ 3.4K
Operating Temperature (°C)	-25 ~ +50
Dimension (mm)	Φ40.0xH7.4
Material	Metal

Characteristic

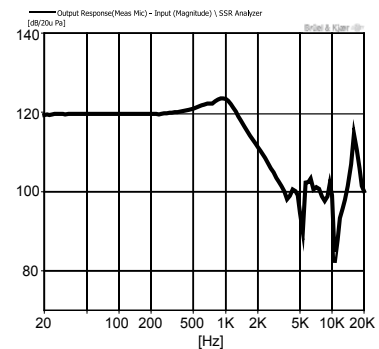

Square Type

Dynamic Receiver

KDRG0612C-008



Dimension

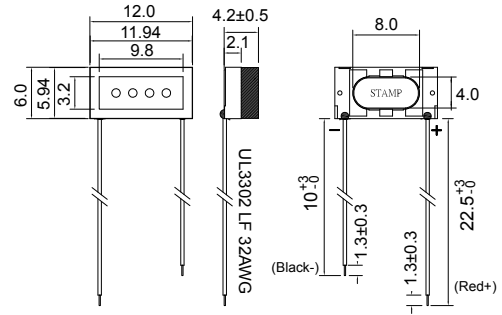

Tol: ± 0.5 Unit: mm

Rated Power (mW)	100
Max. Input Power (mW)	150
Sound Pressure Level (dB)	114 ± 3@1.0KHz 89mV with IEC318 Coupler
Impedance (Ω)	8 ± 15%@1.0KHz
Frequency Range (Hz)	300 ~ 2.0K
Operating Temperature (°C)	-25 ~ +55
Storage Temperature (°C)	-25 ~ +60
Dimension (mm)	L12.0xW6.0xH2.4

Characteristic

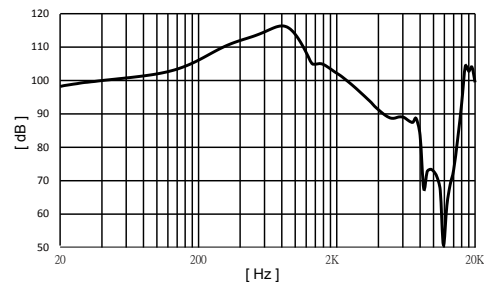

Square Type

Dynamic Receiver

KDRG1506Q-32PF1



Dimension

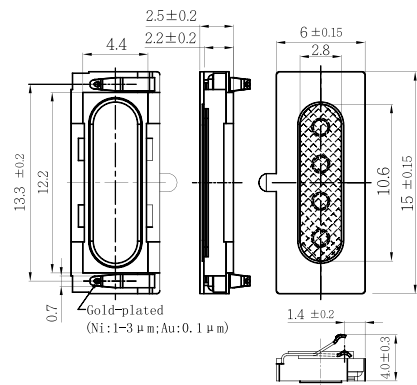

Tol: ± 0.5 Unit: mm

Rated Power (mW)	20
Max. Input Power (mW)	30
Sound Pressure Level (dB)	108 ± 3@1.0KHz, 0dB SPL=20uPa Input 179mVrms, with B&K artificial ear 4153
Impedance (Ω)	32 ± 15%@1.0KHz, 179mVrms input
Frequency Range (Hz)	200 ~ 3.4K
Operating Temperature (°C)	-20 ~ +60
Dimension (mm)	L15.0xW6.0xH2.2
Material	PPA

Characteristic

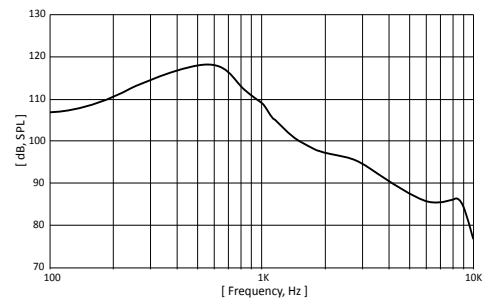

Waterproof Type

Dynamic Receiver

KDRG0612Q-32P



Dimension

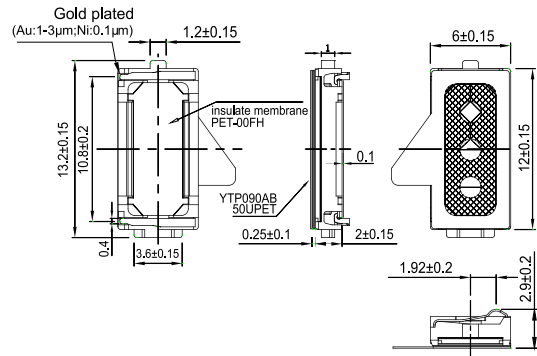

Tol: ± 0.5 Unit: mm

Characteristic

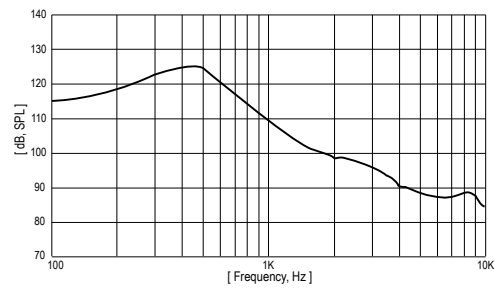

Rated Power (mW)	20
Max. Input Power (mW)	30
Sound Pressure Level (dB)	110 ± 3@1.0KHz, 0dB SPL=20uPa Input 179mVrms, with B&K artificial ear 4153
Impedance (Ω)	32 ± 15%@1.0KHz, 179mVrms
Frequency Range (Hz)	300 ~ 3.4K
Operating Temperature (°C)	-20 ~ +60
Dimension (mm)	L12.0xW6.0xH2.25
Material	PPA