

The information provided herein is from CONNELY Electronic Co., Ltd. and is confidential. Any disclosure to a party other than the recipient is prohibited. The intellectual properties and its rights contained herein, including but not limited to, trademarks, patents, copyrights, trade secrets, and technical know-how, are owned exclusively by CONNELY or its affiliates. Unauthorized use of this information in any format or manner. CONNELY may enforce its intellectual property rights at its own discretion; failures or delays to exercise such rights does not constitute a waiver of such rights.

1 2 3 4 5 6 7 8

Dept	
Qty	
DC	1
ED	1
IE	1
ISO	1
PD	1
R&D	1
SD	1
QA	1
QC	1
QE	1

REV.	DESCRIPTION	DRAWN	CHECKED	APPROVED
A	NEW RELEASE	LL 06/16/06		LJC 06/16/06
B	Arrangement drawing	JLZ 07/23/15'	HWZ 07/23/15'	LJC 07/23/15'
C	Drawing Update	JLZ 04/28/19'		

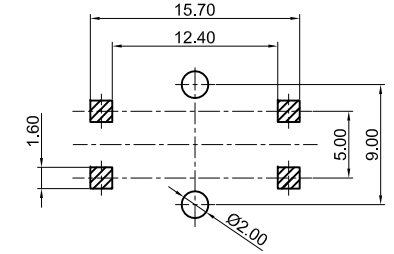

RECOMMEND PCB LAYOUT(Tolerance=±0.05)

NOTES:

1. SPECIFICATIONS

- switch function: Single pole Single throw
- contact rating: 50mA at 12vdc
- insulation resistance:100MQ min at 500vdc
- contact resistance:100mΩ max
- operating life:100,00 cycles

- stop strength: place the switch such that vertical, a static load of 3kgf shall be applied in the direction of stem,operation for a period of 15 secs.
- stroke: (6x6)0.25<sup>+0.2mm/-0.1mm</sup> (12x12)0.35±0.1mm
- operation temperature range: -20°C to 70°C
- storage temperature range: -20°C to +70°C
- wave soldering: recommended solder temperature at 500°F(260°C)max. 5 seconds,subject to PCB 1.6mm thickness.
- hand soldering: usea soldering iron of 30 watts,controlled at 608°F(320°C)approximately 2 seconds while applying solder.

3. PRODUCT NUMBER CODE:

DS1042 - 01 - X X X X X X X X

- Operating Life  
5: 50000 cycles  
10: 100000 cycles  
20: 200000 cycles
- Operating Force  
130: 130gf 160: 160gf  
170: 170gf 250: 250gf
- Cover Type  
X: W/O Cover  
S: W/ Cover(For H=7.3mm only)
- Packing Type  
A: Polybag  
B: Tube  
R: Tape on Reel
- Actuator Color  
U: Blue K: Black N:Brown R: Red  
S: Salmon Y: Yellow
- Housing Color  
U: Blue K: Black N:Brown R: Red  
S: Salmon Y: Yellow
- Profile Height(DIM.H, H>7.3 The cover is cylindrical,Black)  
1:4.3mm 2:5.0mm 3:7.0mm 4:7.3mm  
5:9.5mm 6:13.0mm 7:7.5mm 8:8.0mm  
9:8.5mm 10:12.0mm 11:12.5mm 12:17.0mm  
13:7.8mm 14:9.0mm 15:10.0mm 16:11.0mm
- Size  
2:12mmX12mm

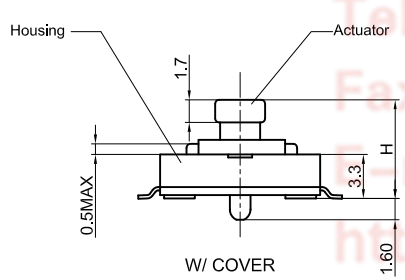
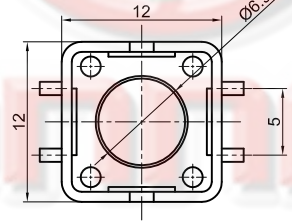
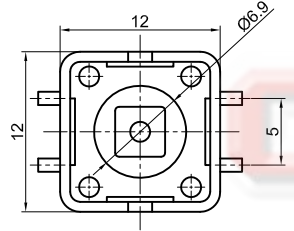

W/ COVER

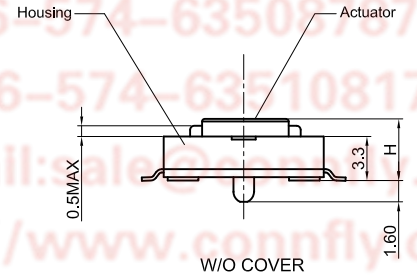

W/O COVER

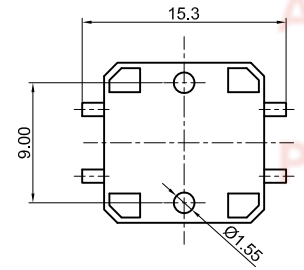

GENERAL TOLERANCE		ANGLE TOLERANCE	
X.	±0.60	X.	±5°
.X	±0.38	.X	±3°
.XX	±0.25	.XX	±2°
DRAWING TYPE		CUSTOMER	
SCALE		1:1	SHEET 1 OF 1
DRAWING NO.		C-DS1042-01-XXXXXXX-C	

PROJECTION		TITLE	Tact Switch SMT Type
UNITS	mm		
SHEET SIZE	A4	SERIES	DS1042-01 SERIES

**晨翔电子有限公司**  
**CONNFLY CONNELY ELECTRONIC CO. LTD**

1 2 3 4 5 6 7 8