

RoHS Compliant

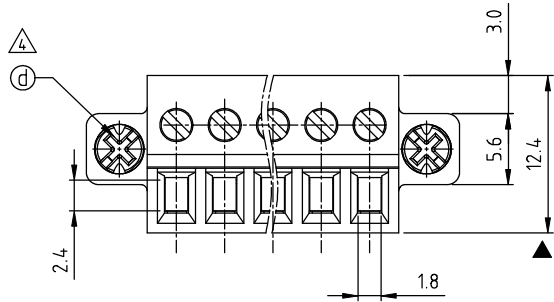

VM xx 3 5 x 2 xxxx G

- Solid Block
 02 2 CONTACTS
 03 3 CONTACTS
 ...
 24 24 CONTACTS

- Color
 0 Black (RAL9005)
 2 Red (RAL3001/D)
 3 Orange(RAL2011/P)
 4 Yellow(RAL1018/A)
 5 Green(RAL6018/T)
 6 Blue (RAL5015/A)
 8 Grey(RAL7035/D)
 9 White(RAL1102)
 C Green(RAL6018/U)

G RoHS compliant (lead<4%) In copper Alloy
 0000: "@logo"
 000A: "ANYTEK"logo
 Any special item by customer request. please contact sales department.

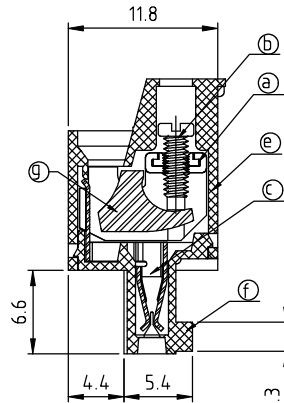
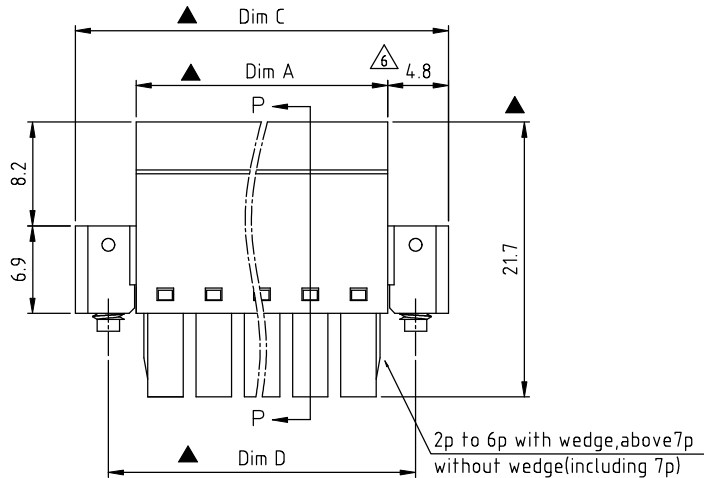

SECTION P-P

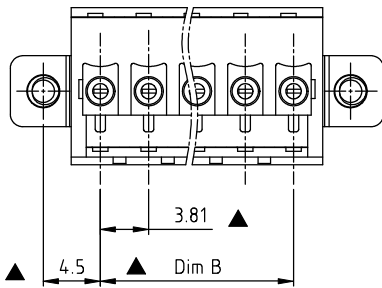

| Rev. | SIGN | DATE | DESCRIPTION | APPROVER |
|------|------|------------|--|----------|
| B | △ | 11/25'04 | The dimension changed from N×3.81 TO N×3.81+0.80 | 何恩華 |
| C | △ | 11/25'04 | Part No. changed from VMxx35x2 to VMxx35x2G | 何恩華 |
| D | △ | 02/07'06 | Part No. changed | Tony |
| E | △ | 12/02'08 | Flange screw changed from "-" to "+/-" | Kind |
| F | △ | 2010.03.11 | Add the rib for 2P - 6P | Jacke |
| G | △ | 05/28'14 | change the dimension from 4.4 to 4.8 | Chen Bo |
| | △ | 06/26'19 | Add the "RoHS compliant & Amphenol logo" | Guoxue |
| | △ | 06/26'19 | Add the "VDE & VDE parameter" | Guoxue |

THIS IS CAD DRAWING, DO NOT REVISE MANUAL Y!!!

Material

- ItemⓐClamp: Steel Zinc plated.
 - ItemⓑTerminal screw: Steel Zinc plated "-" slot type
 - ItemⓒFemale contact: PhBz Tin plated
 - ItemⓓWith flange screw: Steel zine plated M2.5"+/-"slot type
 - ItemⓔTop body: Thermoplastic (UL94V-0)
 - ItemⓕBottom body: Thermoplastic (UL94V-0)
 - ItemⓖClampage:Steel Zinc plated
- △ Electrical cULus VDE
- Voltage rating: 300V 300V(II/2)
 - Current rating: 10A 10A
 - Wire range: 0.2-1.5mm²
 - Solid wire(AWG): 16-28
 - Stranded wire(AWG): 16-28
 - Torque: 1.7Lb-In / 0.2N.m
 - Screw: M2
 - Wire strip length: 6-7mm
 - Withstanding Voltage: 1.6KV
 - Rated impulse voltage(II/2): 2.5KV
 - Operating temperature: -40°C to +115°C
 - Safety approval:
 - Critical dimension: ▲

N = Number of poles
 Dim A=N×3.81+0.80
 Dim B=(N-1)×3.81
 Dim C= N×3.81+10.4 △
 Dim D= (N-1)×3.81+9.0

| Poles | Dim A | Dim B | Dim C | Dim D |
|--------|-------|-------|-------|-------|
| 2-6p | ±0.20 | ±0.20 | ±0.20 | ±0.20 |
| 7-12p | ±0.25 | ±0.25 | ±0.25 | ±0.25 |
| 13-18p | ±0.30 | ±0.30 | ±0.30 | ±0.30 |
| 19-24p | ±0.40 | ±0.40 | ±0.40 | ±0.40 |

Amphenol
ANYTEK

CUSTOMER COPY

ALL RIGHTS RESERVED. REPRODUCTION OR ISSUE TO THIRD PARTIES IN ANY FORM WHATEVER IS NOT PERMITTED WITHOUT WRITTEN AUTHORITY FROM THE PROPRIETOR. PROPERTY OF ANYTEK TECHNOLOGY CO., LTD

| | | | | |
|--------------|---------------|-----------------------------------|----------------------|------------|
| TITLE | | VM 3.81mm W/Flange Series | | |
| PART NO. | VMxx35x2xxxxG | DWG NO. | 8VM0202 | |
| APPROVED | CHECKED | DESIGNED | DRAWN | CUST NO. |
| | | Guoxue 2019.06.26 | Guoxue 2019.06.26 | |
| | | | | Tolerance |
| | | | | X. ±0.50 |
| | | | | X.X ±0.30 |
| | | | | X.XX ±0.10 |
| | | | | X° ±1° |
| SHEET: 01/01 | | UNIT: mm SCALE: NONE REV: G | | |