

RECOMMENDED  
PANEL CUT OUT

RoHS

IP66~68

P/N No.	L
CBP	3.5
CBD	3.8
CBN	3.8

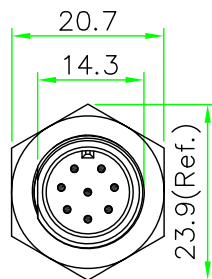
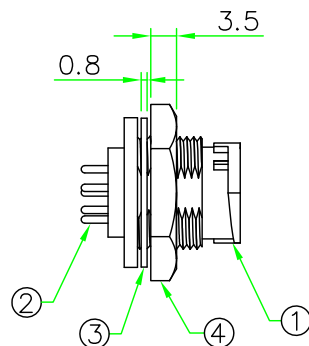
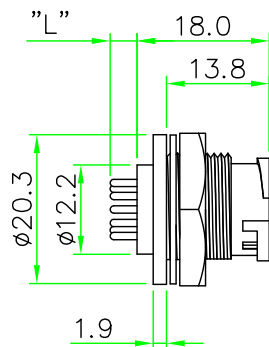

REV.	DESCRIPTION	DATE
A	ISSUE	Jun/06/2014
A1	Add CBP Pin Assignment	May/22/2015

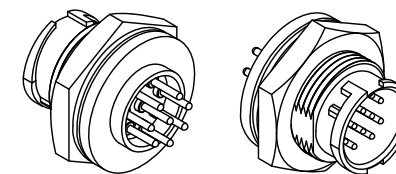

NOTES:

- ELECTRICAL CHARACTERISTICS:  
CURRENT RATING: 2A / 5A / 10A  
CONNECTOR TEMPERATURE RANGE: -25°C TO +85°C  
DIELECTRIC WITHSTANDING VOLTAGE:  
500V AC FOR ONE MINUTE
- PANEL THICKNESS MAX. 9.0mm
- HOW TO ORDER: CBx-L1xxCPR

- 02 - 2 PIN    07 - 7 PIN
- 03 - 3 PIN    08 - 8 PIN
- 04 - 4 PIN    10 - 10 PIN
- 05 - 5 PIN    12 - 12 PIN
- 06 - 6 PIN

- P - CURRENT RATING 10A
- D - CURRENT RATING 5A
- N - CURRENT RATING 2A

PIN ASSIGNMENT AND PCB LAYOUT SEE NEXT PAGE

**HOLIN**® HTP ASIA TECHNOLOGY CO., LTD.  
禾凌科技股份有限公司

	UNIT: mm	TITLE : Circular B Size Male Connector Male Pin Rear Mount Lock Type Round Flange PCB Pin	
SCALE	1:1	P/N: CBx-L1xxCPR	DR. Patty
UNLESS OTHERWISE SPECIFIED TOLERANCES: .x ± 0.25 .xx ± 0.1 .xxx ± 0.05 ANGLE ± 1°			CH. ERIC
REV. A1	SHEET 1/2	DWG.NO: CBx-L1xxCPR	AP.

No.	PART NAME	DESCRIPTION	COLOR	QTY	REMARKS
4	HEX NUT	Nylon + GF.	BLACK	1	
3	GASKET	EPDM.	BLACK	1	
2	CONTACT	Brass , 6 u" Gold Plated . Male Contact.		N	
1	CONNECTOR	B Size Male Connector Insert.NYLON+GF.	BLACK	1	

REV.	DESCRIPTION	DATE
A	ISSUE	Jun/06/2014
A1	Add CBP Pin Assignment	May/06/2015

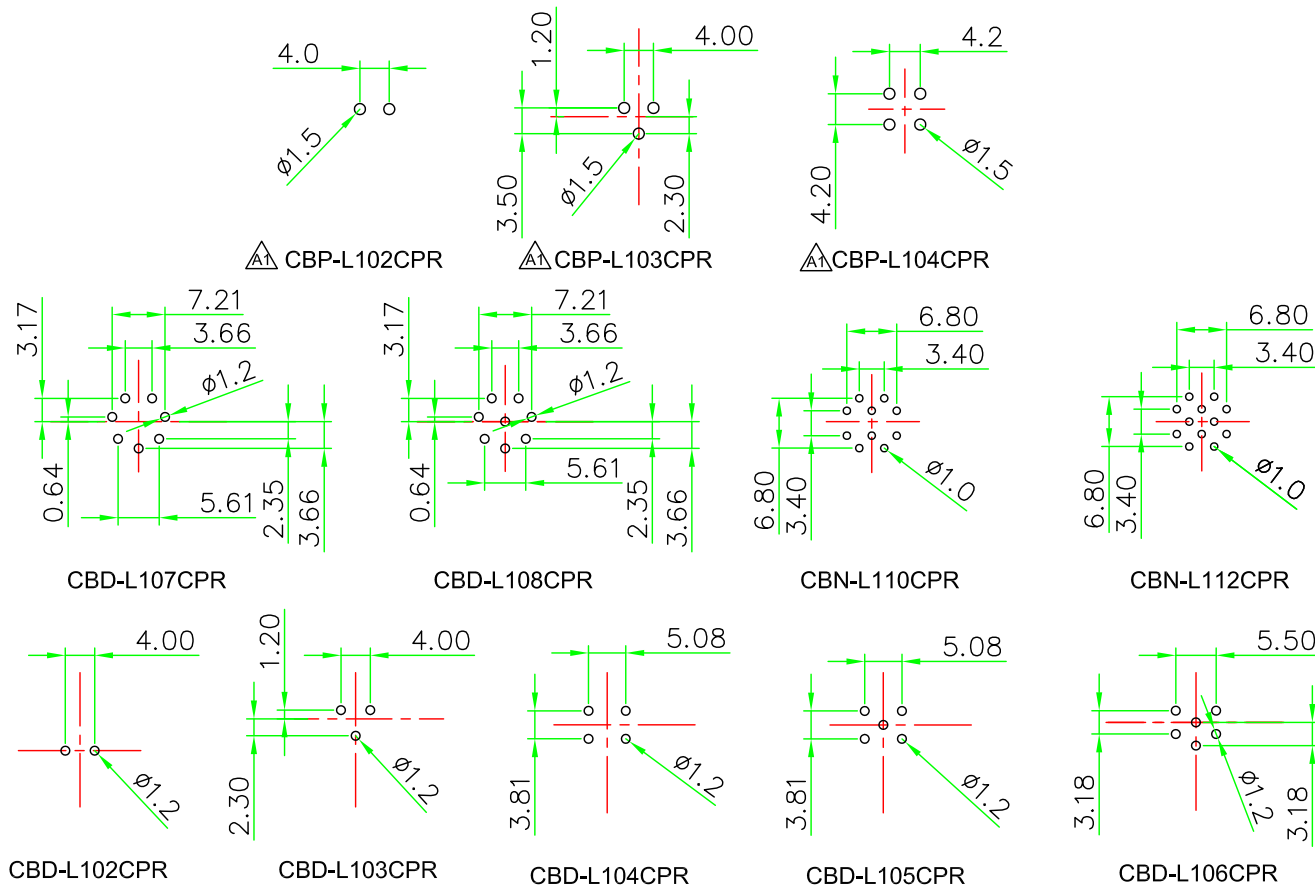

PCB LAYOUT

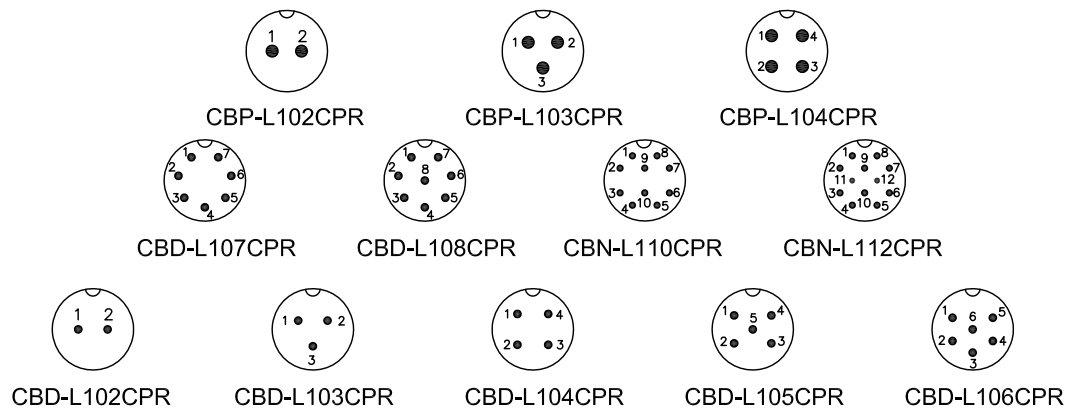

PIN ASSIGNMENT FRONT VIEW

(前視圖)

<b>HOLIN<sup>®</sup> HTP ASIA TECHNOLOGY CO., LTD.</b> <b>禾凌科技股份有限公司</b>			
	UNIT: mm	TITLE : Circular B Size Male Connector Male Pin Rear Mount Lock Type Round Flange PCB Pin	
SCALE	1:1	P/N: CBx-L1xxCPR	DR. Patty
UNLESS OTHERWISE SPECIFIED TOLERANCES: .x ± 0.25 .xx ± 0.1 .xxx ± 0.05 ANGLE ± 1°			CH. ERIC
REV. A1	SHEET 2/2	DWG.NO: CBx-L1xxCPR	AP.