

RoHS
IP66~68

NOTE	DESCRIPTION	DATE
1	Add Dimension.	Feb/12/2019
2	Correct Dimension & Note.	Mar/16/2020

PIN	D
A12D	∅0.8
A12N	∅0.6
A12I	∅0.6

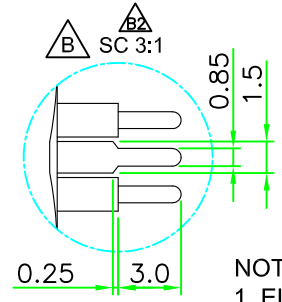
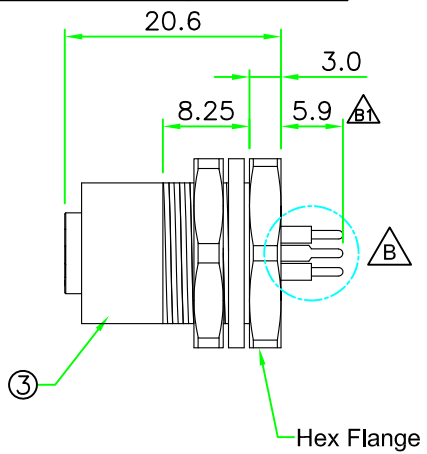

- NOTES:
- ELECTRICAL CHARACTERISTICS:
CURRENT RATING: 1.5A / 2A / 4A
TEMPERATURE RANGE: -25°C TO +85°C
DIELECTRIC WITHSTANDING VOLTAGE:
500V AC FOR ONE MINUTE
 - PANEL THICKNESS MAX. 3.0mm
 - HOW TO ORDER: A12x-S2xxHPR

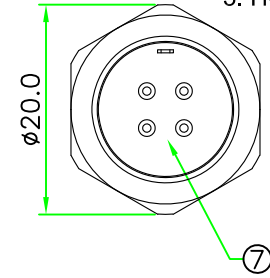
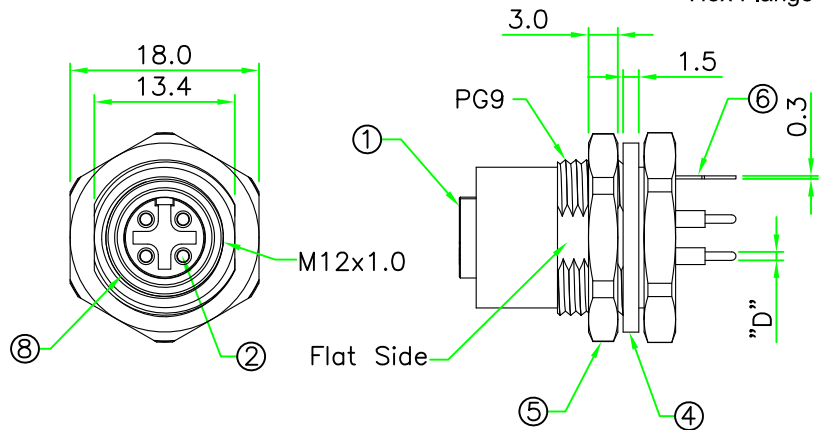

- | | | |
|-------------|--------------|--------------|
| 02 - 2 PINS | 08 - 8 PINS | 14 - 14 PINS |
| 03 - 3 PINS | 09 - 9 PINS | 15 - 15 PINS |
| 04 - 4 PINS | 10 - 10 PINS | 16 - 16 PINS |
| 05 - 5 PINS | 11 - 11 PINS | 17 - 17 PINS |
| 06 - 6 PINS | 12 - 12 PINS | |
| 07 - 7 PINS | 13 - 13 PINS | |
- I - CURRENT RATING 1.5A
N - CURRENT RATING 2A
D - CURRENT RATING 4A

*Pin Assignment Next Page.

8	O-RING	Viton.	BLACK	1	
7	GLUE	Epoxy.	BLACK		
6	SHIELD PIN	Brass, Nickel Plated.		1	
5	HEX NUT	Brass, Nickel Plated. PG9 Thread.		1	
4	GASKET	EPDM	BLACK	1	
3	HOUSING	Brass, Nickel Plated.		1	
2	CONTACT	Brass, 6 u" Gold Plated. Female Contact.		N	
1	CONNECTOR	M12 A-Coding Female Connector Insert. Nylon+GF.	BLACK	1	
No.	PART NAME	DESCRIPTION	COLOR	Q'TY	REMARKS

HOLIN® HTP ASIA TECHNOLOGY CO., LTD.
禾凌科技股份有限公司

UNIT: mm
SCALE: 1.5:1

TITLE: M12 A-Coding Female Panel Connector Rear mount Hex Flange With PCB and Shielded Pin

P/N: A12x-S2xxHPR
DR. SIBYL
CH. ERIC

DWG.NO: A12x-S2xxHPR
AP.

UNLESS OTHERWISE SPECIFIED TOLERANCES:
X ±0.5 XX ±0.25
XXX ±0.1 ANGLE ± 1°

REV. B SHEET 1/2

REV.	DESCRIPTION	DATE	NOTE
A	ISSUE	Dec/10/2015	
A1	Add 13~17 Pin.	Oct/04/2018	
B	Change shape of Shielded Pin.	Nov/20/2018	2

NOTE	DESCRIPTION	DATE
1	Add Dimension.	Feb/12/2019
2	Correct Dimension & Note.	Mar/16/2020

REV.	DESCRIPTION	DATE	NOTE
A	ISSUE	Dec/10/2015	
A1	Add 13~17 Pin.	Oct/04/2018	
B	Change shape of Shielded Pin.	Nov/20/2018	2

A1 B2

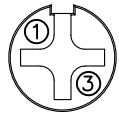

A12D-S202HPR

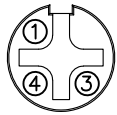

A12D-S203HPR

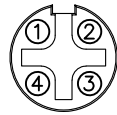

A12D-S204HPR

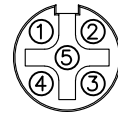

A12D-S205HPR

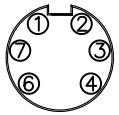

A12N-S206HPR

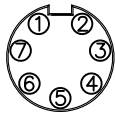

A12N-S207HPR

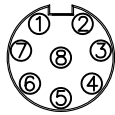

A12N-S208HPR

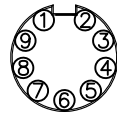

A12I-S209HPR

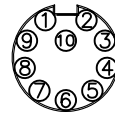

A12I-S210HPR

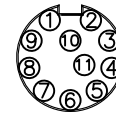

A12I-S211HPR

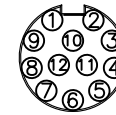

A12I-S212HPR

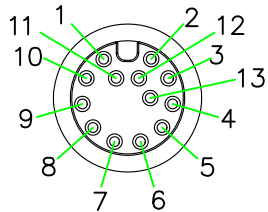

A12I-S213HPR

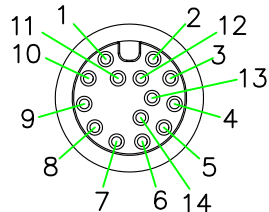

A12I-S214HPR

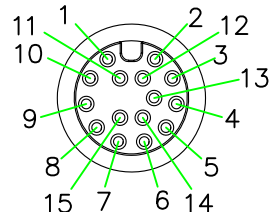

A12I-S215HPR

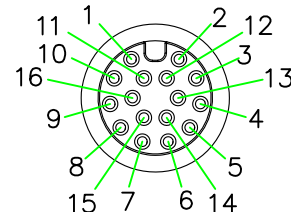

A12I-S216HPR

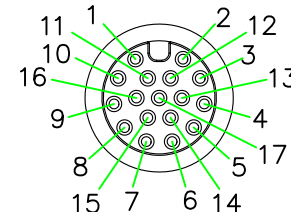

A12I-S217HPR

PIN ASSIGNMENT FRONT VIEW
(前視圖)

HOLIN[®] HTP ASIA TECHNOLOGY CO., LTD. 禾凌科技股份有限公司			
	UNIT: mm	TITLE : M12 A-Coding Female Panel Connector Rear mount Hex Flange With PCB and Shielded Pin	
SCALE	2:1	P/N:	A12x-S2xxHPR
UNLESS OTHERWISE SPECIFIED TOLERANCES: X ±0.5 XX ±0.25 XXX ±0.1 ANGLE ± 1'		DWG.NO:	A12x-S2xxHPR
REV.	SHEET	DR.	SIBYL
B	2/2	CH.	ERIC
		AP.	

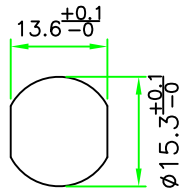

Recommended Panel Cut Out

RoHS
IP66~68

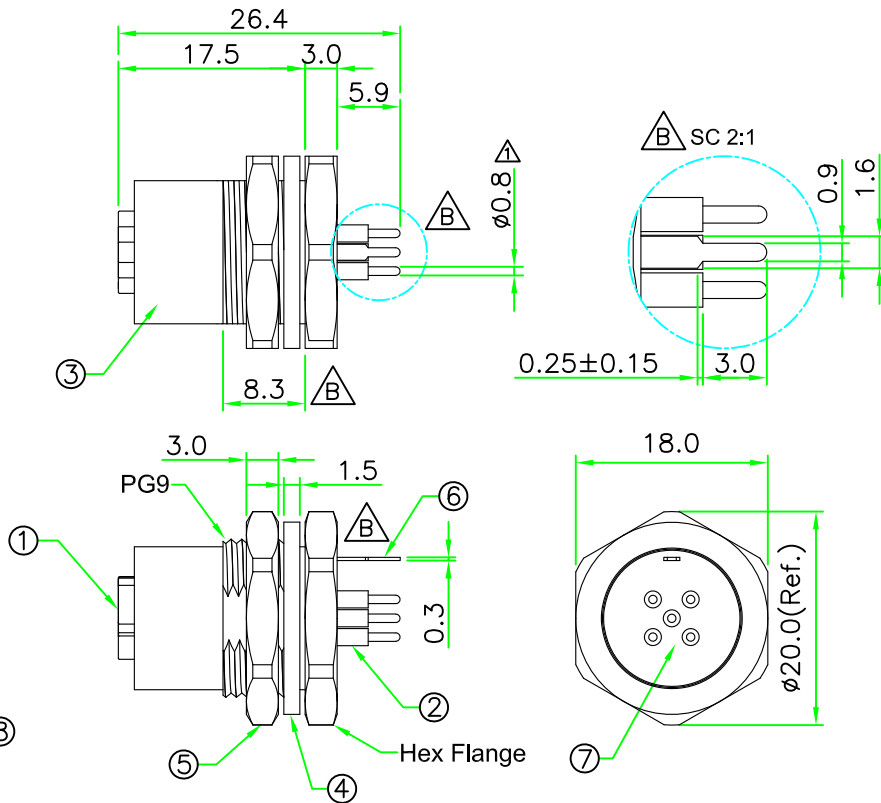
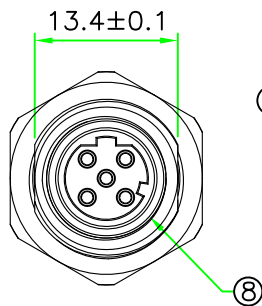

REV.	DESCRIPTION	DATE
A	ISSUE	Ju/08/2015
B	Change Shielded Pin Design.	Oct/19/2018

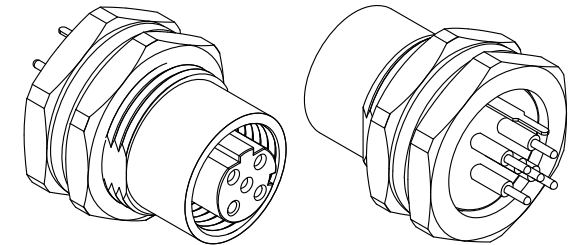

- NOTES:
- ELECTRICAL CHARACTERISTICS:
CURRENT RATING: 4A
TEMPERATURE RANGE: -25°C TO +85°C
DIELECTRIC WITHSTANDING VOLTAGE:
500V AC FOR ONE MINUTE
 - PANEL THICKNESS MAX. 3.0mm
 - HOW TO ORDER: D12D-S2xxHPR

- 03 - 3 PIN
- 04 - 4 PIN
- 05 - 5 PIN

Notes:
1. Correct PCB hole dia. & add pin dia.

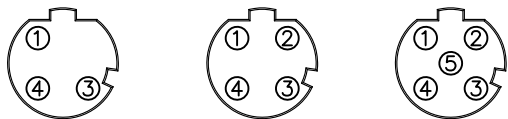

D12D-S203HPR D12D-S204HPR D12D-S205HPR
Pin Assignment Front View
(前視圖)

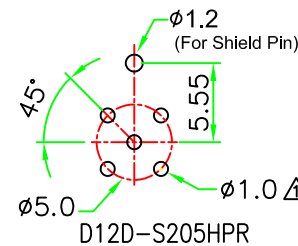
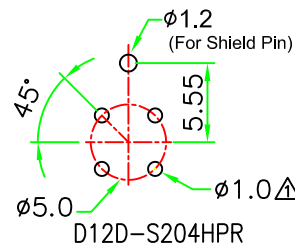
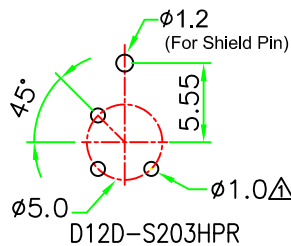

D12D-S203HPR D12D-S204HPR D12D-S205HPR
PCB LAYOUT

No.	PART NAME	DESCRIPTION	COLOR	Q'TY	REMARKS
8	O-RING	Viton.	BLACK	1	
7	GLUE	Epoxy.	BLACK	1	
6	SHIELD PIN	Brass, Nickel Plated.		1	
5	HEX NUT	Brass, Nickel Plated. PG9 Thread.		1	
4	GASKET	Rubber.	BLACK	1	
3	HOUSING	Brass, Nickel Plated.		1	
2	CONTACT	Brass, 6 u" Gold Plated . Female Contact.		N	
1	CONNECTOR	M12 D-Coding Female Connector Insert. Nylon+GF.	BLACK	1	

HOLIN® HTP ASIA TECHNOLOGY CO., LTD.
禾凌科技股份有限公司

UNIT: mm	TITLE : M12 D-Coding Female Connector Female Pin Rear Mount Hex Flange PCB Mount PCB Pin with Shield Pin
SCALE 1.5:1	
UNLESS OTHERWISE SPECIFIED TOLERANCES: .x ± 0.5 .xx ± 0.25 .xxx ± 0.1 ANGLE ± 1'	P/N: D12D-S2xxHPR
REV. B SHEET 1/1	DR. JAMES CH. ERIC AP.
DWG.NO: D12D-S2xxHPR	

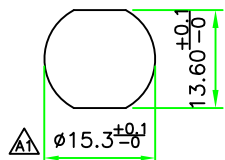

Recommended Panel Cut Out

RoHS
IP66~68

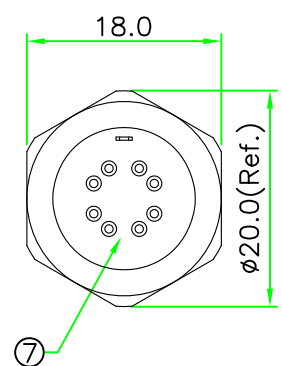
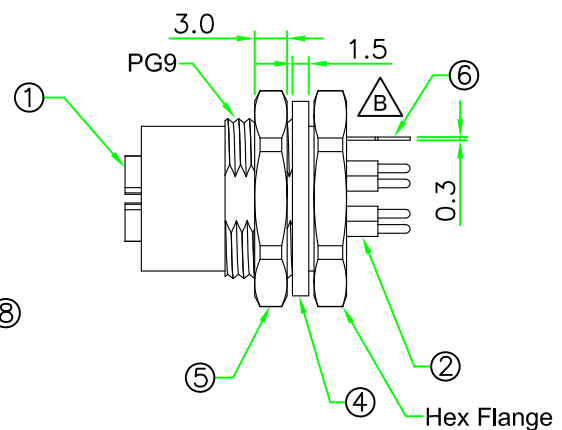
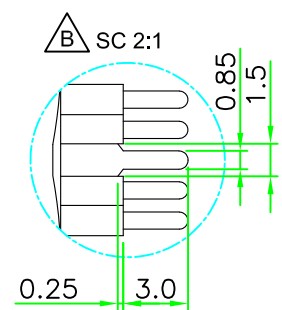
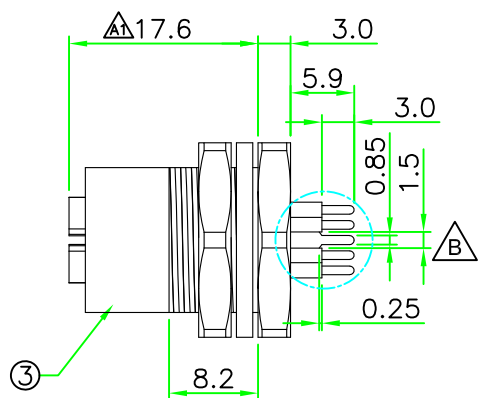
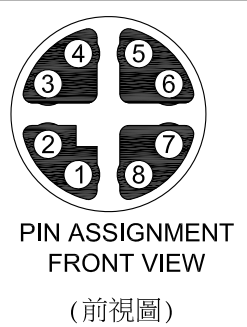
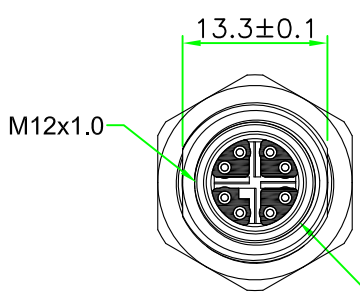

REV.	DESCRIPTION	DATE
A	ISSUE	Oct/01/2014
A1	Correct dimensions	Ju/06/2016
B	Change Shielded Pin Design.	Oct/19/2018

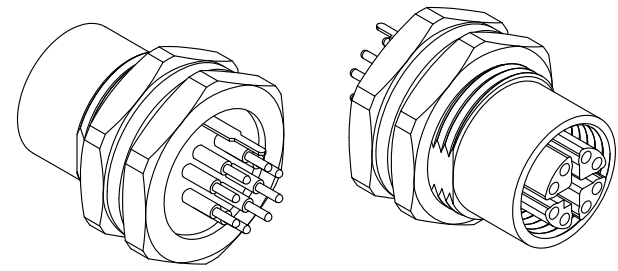

NOTES:
1. ELECTRICAL CHARACTERISTICS:
CURRENT RATING: 0.5A
TEMPERATURE RANGE: -25°C TO +85°C
DIELECTRIC WITHSTANDING VOLTAGE:
500V AC FOR ONE MINUTE

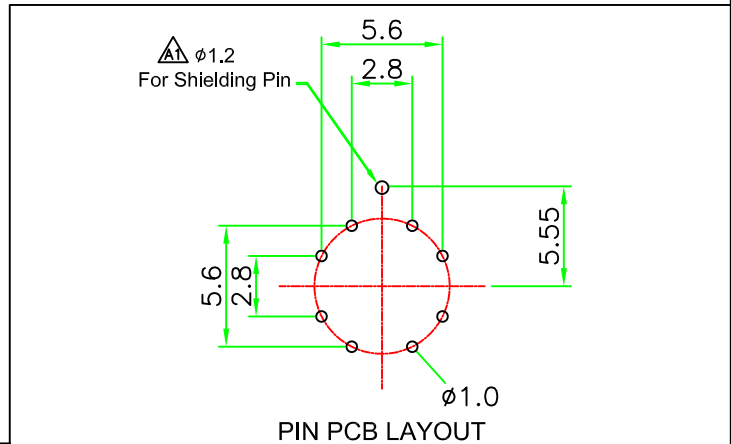

HOLIN® HTP ASIA TECHNOLOGY CO., LTD.
禾凌科技股份有限公司

No.	PART NAME	DESCRIPTION	COLOR	Q'TY	REMARKS
8	O-RING	Viton.	BLACK	1	
7	GLUE	Epoxy.	BLACK	1	
6	SHIELD PIN	Brass, Nickel Plated.		1	
5	HEX NUT	Brass, Nickel Plated. PG9 Thread.		1	
4	GASKET	Rubber.	BLACK	1	
3	HOUSING	Brass, Nickel Plated.		1	
2	CONTACT	Brass , 6 u" Gold Plated . Female Contact.		8	
1	CONNECTOR	M12 X-Coding Female Connector Insert. Nylon+GF.	BLACK	1	

UNIT: mm	TITLE : M12 X-Coding Female Connector Female Pin Rear Mount Hex Flange PCB Pin with Shield Pin	DR. SIBYL
SCALE 1.5:1	P/N: X12I-S208HPR	CH. ERIC
UNLESS OTHERWISE SPECIFIED TOLERANCES: .X ± 0.5 .XX ± 0.25 .XXX ± 0.1 ANGLE ± 1°	DWG.NO: X12I-S208HPR	AP.
REV. B	SHEET 1/1	