

The information provided herein is from CONNELY Electronic Co., Ltd. and is confidential. Any disclosure to a party other than the recipient is prohibited. The intellectual properties and its rights contained herein, including but not limited to, trademarks, patents, copyrights, trade secrets, and technical know-how, are owned exclusively by CONNELY or its affiliates. Unauthorized use of this information in any format or manner. CONNELY may enforce its intellectual property rights at its own discretion; failures or delays to exercise such rights does not constitute a waiver of such rights.

NOTES:

1. SPECIFICATIONS

- . Contact Rating: 300mA at 36Vdc
- . Insulation Resistance: 100MΩ min.
- . Contact Resistance: 100mΩ max.
- . Dielectric Withstanding Voltage: 250V AC(rms) for 1 minute.
- . Operating Life: 5,000 cycles
- . Operating force: 230±30gf
- . Operation Temperature Range: -40°C to +70°C

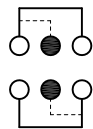
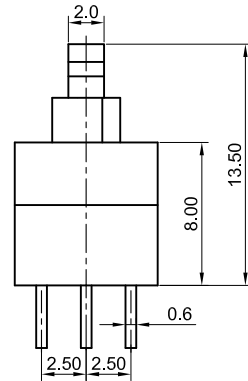
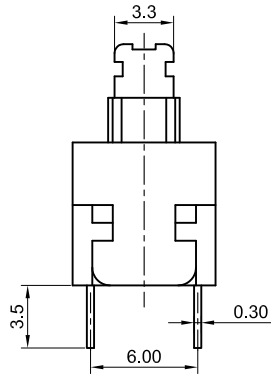
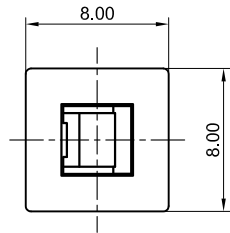

CIRCUIT DIAGRAM

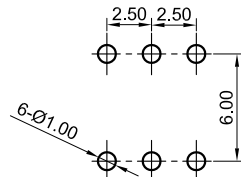

RECOMMEND P.C.B LAYOUT
Tolerance±0.05

REV.	DESCRIPTION	DRAWN	CHECKED	APPROVED
A	NEW RELEASE	JLZ 09/03/18'		

- . Wave Soldering: Recommended Solder Temperature At 392°F(200°C)max. 5 Seconds
- . Hand Soldering: Use Soldering Iron Of 30 Watts, Controlled At 660°F(350°C) Approximately 3 Seconds.

2. PRODUCT NUMBER CODE:

DS1041-17 - X X X X X X X

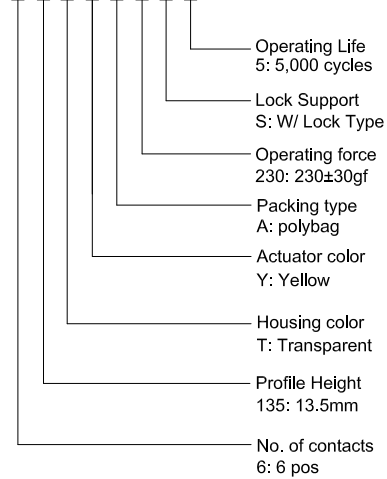

GENERAL TOLERANCE		ANGLE TOLERANCE		PROJECTION		TITLE		8.0*8.0*13.5mm Tact Switch V/T 6 Positions W/ Lock Type	
X.	±0.60	X.	±5°	UNITS	mm	SERIES		DS1041-17 SERIES	
.X	±0.38	.X	±3°	SHEET SIZE		A4			
.XX	±0.25	.XX	±2°	晨翔电子有限公司 CONNELY CONNELY ELECTRONIC CO. LTD					
DRAWING TYPE		CUSTOMER							
SCALE		1:1							
DRAWING NO.		C-DS1041-17-XXXXXXXXXX-A							