

Recommended
Panel Cut-Off

RoHS
IP67

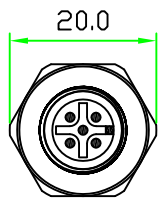

Circular Flange

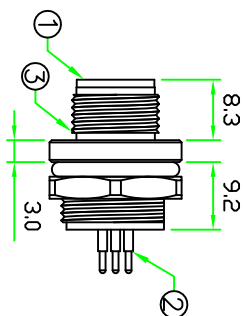
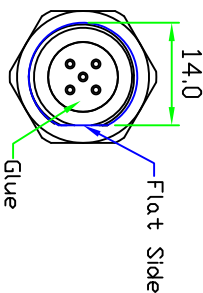
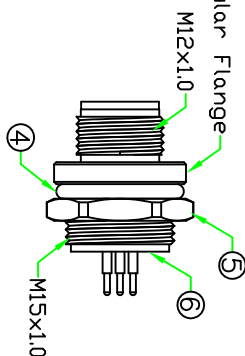

Flat Side

Glue

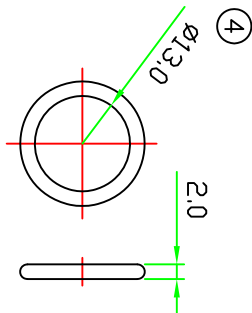
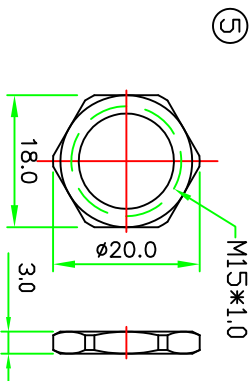
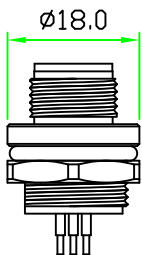

6	GLUE	GLUE.	BLACK	1	
5	HEX NUT	BRASS, NICKEL PLATED.		1	
4	O-RING	SILICON.	BROWN	1	
3	HOUSING	BRASS, NICKEL PLATED.		1	
2	CONTACT	Brass, 6 u" Gold plated .Male Contact.		n	
1	CONNECTOR	M12 A-Coding Male connector insert.	BLACK	1	
No.	PART NAME	DESCRIPTION			

REV.	DESCRIPTION	DATE
A	ISSUE	Feb/12/2005

NOTES:

- ELECTRICAL CHARACTERISTICS:
CURRENT RATING: 2A / 5A
TEMPERATURE RANGE: -25°C TO +85°C
DIELECTRIC WITHSTANDING VOLTAGE:
500V AC FOR ONE MINUTE
- HOW TO ORDER: A12X-M1XXCPF

- 03 - 3 PINS 08 - 8 PINS
- 04 - 4 PINS
- 05 - 5 PINS
- D - CURRENT RATING 5A
- N - CURRENT RATING 2A

HOLIN HTP ASIA TECHNOLOGY CO., LTD.
禾凌科技 股份有限公司

Pin Assignment Front View

A12D-M105CPF

A12N-M108CPF

UNLESS OTHERWISE SPECIFIED TOLERANCES:
X ±0.25 XX ± 0.1
XXX ± 0.05 ANGLE ± 1°X

SCALE	UNIT: mm	TITLE :	M12 A-Coding MALE PCB PIN FRONT MOUNT ROUND FLANGE PANEL CONNECTOR
P/N:	A12x-M1xxCPF	DR:	Stanley
REV:	A	CH:	NJCJL
DWG.NO:	A12x-M1xxCPF	AP:	
SHEET	1/2		

PIN LAYOUT PCB

REV.	DESCRIPTION	DATE
A	ISSUE	Feb/12/2005

3, 4, 5 POLES

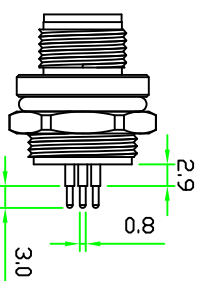

8 POLES

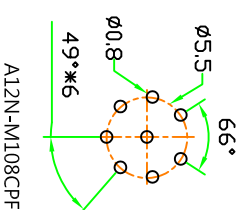
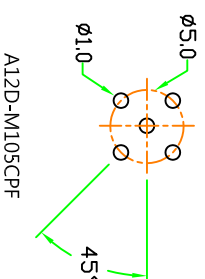
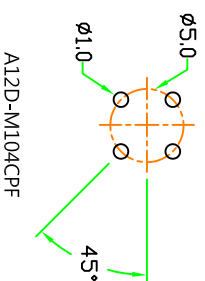
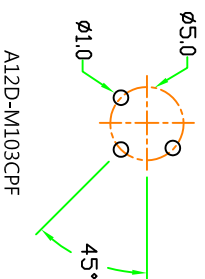
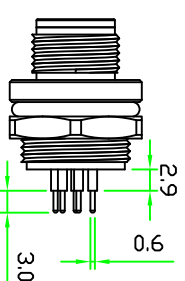

HOLIN ® HTP ASIA TECHNOLOGY CO., LTD. 禾凌科技股份有限公司		TITLE : M12 A-Coding MALE PCB PIN FRONT MOUNT ROUND FLANGE PANEL CONNECTOR	
SCALE 1:1 <small>UNLESS OTHERWISE SPECIFIED TOLERANCES: X ±0.25 XX ±0.1 XXX ±0.05 ANGLE ±1°</small>	P/N: A12x-M1xxCPF	DR: Stanley CH: NJCJL AP:	
REV: A SHEET 2/2	DWG.NO: A12x-M1xxCPF		