

RECOMMENDED PCB LAYOUT

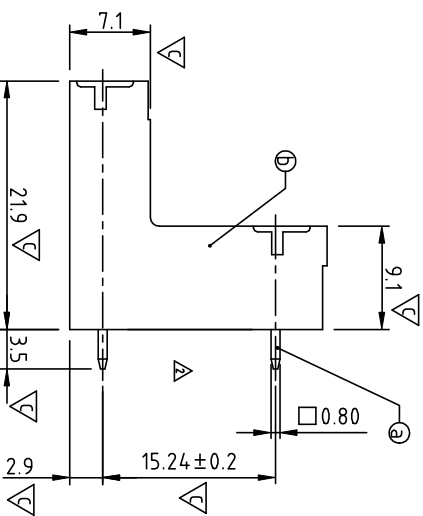
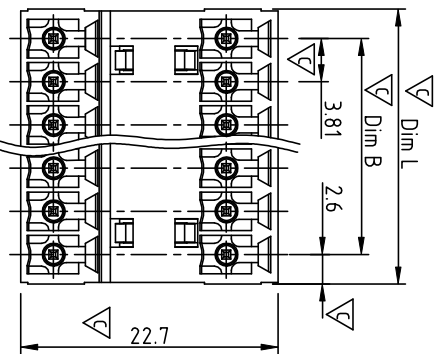

Poles	2x2p	2x3p	2x4p	2x5p	2x6p	2x7p	2x8p	2x9p	2x10p	2x11p	2x12p	2x13p
Dim L	9.01	12.82	16.63	20.44	24.25	28.06	31.87	35.68	39.49	43.30	47.11	50.92
Dim B	3.81	7.62	11.43	15.24	19.05	22.86	26.67	30.48	34.29	38.10	41.91	45.72
TOL	±0.15											
Poles	2x14p	2x15p	2x16p	2x17p	2x18p	2x19p	2x20p	2x21p	2x22p	2x23p	2x24p	
Dim L	54.73	58.54	62.35	66.16	69.97	73.78	77.59	81.40	85.21	89.02	92.83	
Dim B	49.53	53.34	57.15	60.96	64.77	68.58	72.39	76.20	80.01	83.82	87.63	
TOL	±0.25											
	±0.30											
	±0.35											

SIGN	DATE	DESCRIPTION	APPROVER
△	1/30/07	Soldering temperature changed from 245° to 250°	Tony
△	6/04/07	Body is changed from open type to close type	Marvin
△	04/08/09	The current rating and operating temperature are changed	Jacke
△	04/08/09	Add UL Standard	Jacke
△	01/19-15	Update the drawing	Evan

THIS IS CAD DRAWING, DO NOT REVISE MANUALLY!!!

Material:

- Item ② Contact pin: Copper Tin plated
- Item ③ Terminal(housing): PA66 (UL94V-0)

Electrical:

- Voltage rating: 300V
- Current rating: 10A
- Withstanding Voltage: 16 KV
- Operating temperature: -40°C to +115°C
- Safety temperature: 260°C±5°C/5 Sec
- Safety Approval:
- Critical dimension:

VO XX 3 1 X 0 XXXX G

- No. OF POLES: 04: 2x2 POLES
- COLOR: 0 Black (RAL9005), 1 Red (RAL3001/D), 2 Orange(RAL2011/P), 3 Yellow(RAL1018/A), 4 Green(RAL6018/T), 5 Blue (RAL5015/A), 6 Grey(RAL7035/D), 7 White(RAL1102), 8 Green(RAL6018/U)
- 0000: "@ " Logo (Standard)
- 000A: "ANYTEK" Mark
- 0091: "ANYTEK" Mark △
- Any special item by customer request, please contact sales department.
- G: RoHS compliant (lead<4%) In copper Alloy

ANYTEK

CUSTOMER COPY

ALL RIGHTS RESERVED. REPRODUCTION OR ISSUE TO THIRD PARTIES IN ANY FORM WHATSOEVER IS NOT PERMITTED WITHOUT WRITTEN AUTHORITY FROM THE PROPRIETOR. PROPERTY OF ANYTEK TECHNOLOGY CO., LTD.

TITLE	VO-3.81 Series Vertical		DWG NO.	8V00101	Tolerance	
PART NO.	VOxx31x0xxxxxG	DESIGNED	Evan	01/19-15	UNIT: mm	X ±0.50
CHECKED		DRAWN	Evan	01/19-15	SCALE: NONE	X.X ±0.30
APPROVED					REV: G	X.XX ±0.10
					SHEET: 01/01	X° ±1°