

The information provided herein is from CONNELY Electronic Co., Ltd. and is confidential. Any disclosure to a party other than the recipient is prohibited. The intellectual properties and its rights contained herein, including but not limited to, trademarks, patents, copyrights, trade secrets, and technical know-how, are owned exclusively by CONNELY or its affiliates. Unauthorized use or reproduction of any part of this document is strictly prohibited. CONNELY may enforce its intellectual property rights at its own discretion, failures or delays in exercising such rights does not constitute a waiver of such rights.

Dept	
Qty	
DC	1
ED	1
IE	1
ISO	1
PD	1
R&D	1
SD	1
QA	1
QC	1
QF	1

Dimension

Position	A±0.2	B±0.2	C±0.3	D
9	17.90	24.99	30.80	16.33
15	26.50	33.32	39.14	24.66
25	40.00	47.04	53.04	38.38
37	56.50	63.50	69.32	54.84

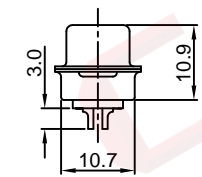
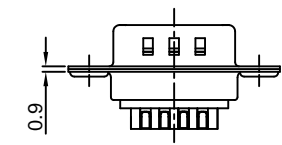
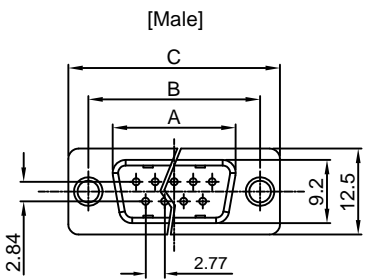
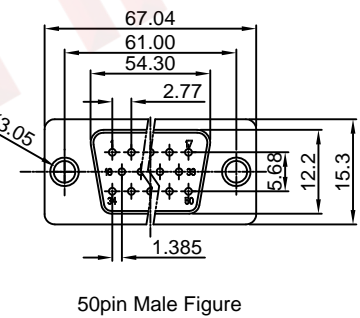
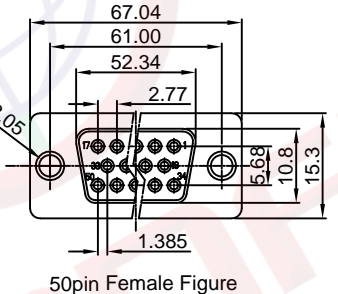
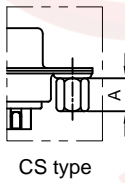
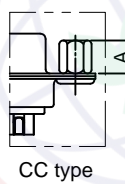
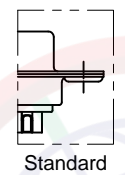
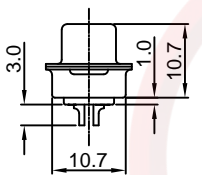
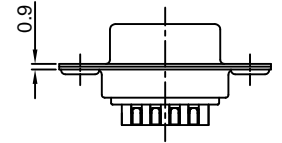
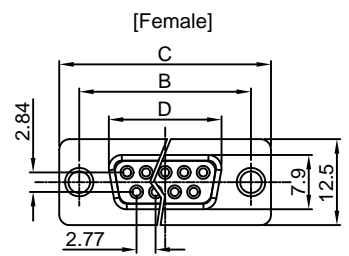

(Series Image-Reference Only)

REV.	DESCRIPTION	DRAWN	CHECKED	APPROVED
A	NEW RELEASE	YCH 03/15/10'		LJC 03/15/10'
G	DRAWING UPDATE	JLZ 01/25/18'		

- NOTES:
- Electrical characteristics:
 - Contact resistance: 20mΩ Max. Initial.
 - Dielectric withstanding voltage: 500V AC(rms) for 1 minute.
 - Insulation resistance: 1000MΩ Min.
 - Environment characteristics:
 - Temperature range: -40°C~+105°C.
 - Materials:
 - Insulator:PBT+Glass fiber
 - Shell:Steel
 - Contact:Copper alloy
 - Product number code:

DS1033-11- X X X X X X X

- Screw DIM. A
- S: Standard(W/O nut)
- 1: 5.00 2: 3.00
- 3: 5.20 4: 4.80
- 5: 5.80 6: 4.00
- Screw type
- S: Standard(W/O nut)
- 1: CC type
- 2: CS type
- Contact plating
- 8: Full gold flash
- Si: Selective gold flash
- 6: Full tin
- Shell plating
- T: Front & Back Tin
- N: Front Nickel,Back Tin
- Housing color
- B: Black W: White
- U: Blue
- Connector type
- M: Male
- F: Female
- No.of contacts
- 09,15,25,37,50

GENERAL TOLERANCE	ANGLE TOLERANCE	PROJECTION		TITLE
X. ±0.60	X. ±5°	UNITS	mm	D-SUB SOLDER (MACHINE PIN)TYPE
.X ±0.38	.X ±3°	SHEET SIZE	A4	SERIES DS1033-11 SERIES
.XX ±0.25	.XX ±2°	晨翔电子有限公司 CONNELY CONNELY ELECTRONIC CO. LTD		
DRAWING TYPE	CUSTOMER			
SCALE	1:1 SHEET 1 OF 1			
DRAWING NO.	C-DS1033-11-XXXXXX-B			