

Recommended  
Panel Cut-Off

**RoHS**  
**IP67**

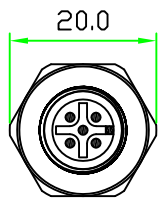

Circular Flange

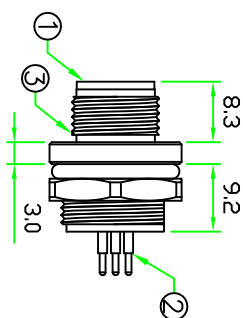
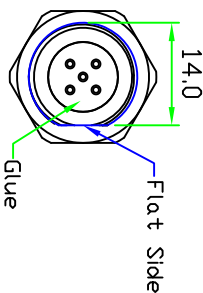
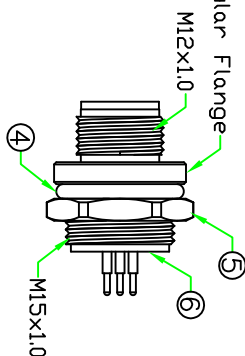

Flat Side

Glue

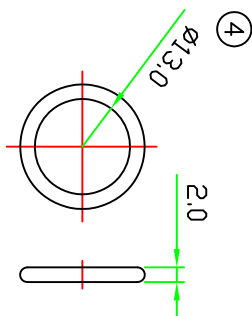
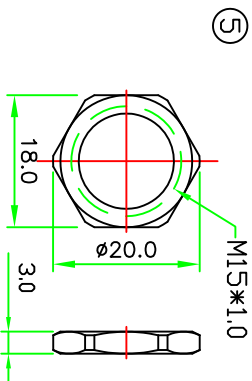
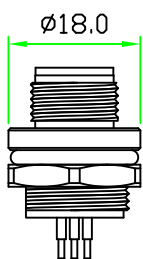

6	GLUE	GLUE.	BLACK	1	
5	HEX NUT	BRASS, NICKEL PLATED.		1	
4	O-RING	SILICON.	BROWN	1	
3	HOUSING	BRASS, NICKEL PLATED.		1	
2	CONTACT	Brass, 6 u" Gold plated .Male Contact.		n	
1	CONNECTOR	M12 A-Coding Male connector insert.	BLACK	1	
No.	PART NAME	DESCRIPTION	COLOR	QTY	REMARKS

REV.	DESCRIPTION	DATE
A	ISSUE	Feb/12/2005

NOTES:

- ELECTRICAL CHARACTERISTICS:  
CURRENT RATING: 2A / 5A  
TEMPERATURE RANGE: -25°C TO +85°C  
DIELECTRIC WITHSTANDING VOLTAGE:  
500V AC FOR ONE MINUTE
- HOW TO ORDER: A12X-M1XXCPF

- 03 - 3 PINS    08 - 8 PINS
- 04 - 4 PINS
- 05 - 5 PINS
- D - CURRENT RATING 5A
- N - CURRENT RATING 2A

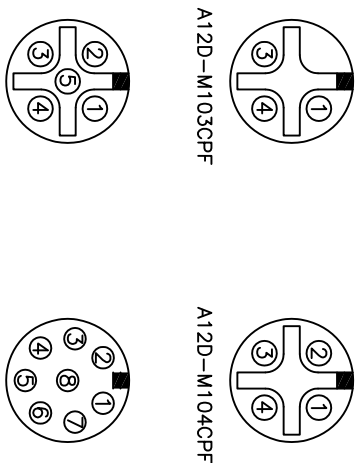

Pin Assignment Front View

**HOLIN** HTP ASIA TECHNOLOGY CO., LTD.  
禾凌科技股份有限公司

TITLE: M12 A-Coding MALE PCB PIN  
FRONT MOUNT ROUND FLANGE  
PANEL CONNECTOR

SCALE: 1:1

UNIT: mm

UNLESS OTHERWISE  
SPECIFIED TOLERANCES:

X ±0.25 XX ±0.1  
XXX ±0.05 ANGLE ±1&#x

REV. SHEET

A 1/2

P/N: A12x-M1xxCPF

DR: Stanley  
CH: NJCJL

DWG.NO: A12x-M1xxCPF

AP:

# PIN LAYOUT PCB

REV.	DESCRIPTION	DATE
A	ISSUE	Feb/12/2005

3, 4, 5 POLES

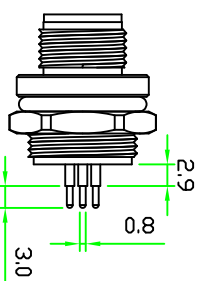

8 POLES

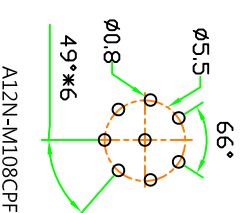
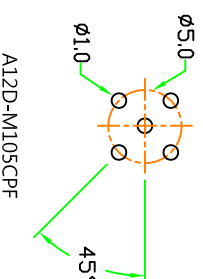
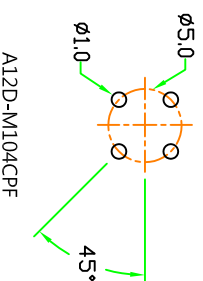
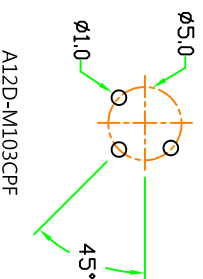
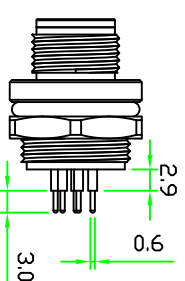

<b>HOLIN</b> HTP ASIA TECHNOLOGY CO., LTD. 禾凌科技股份有限公司		TITLE : M12 A-Coding MALE PCB PIN FRONT MOUNT ROUND FLANGE PANEL CONNECTOR	
SCALE	UNIT: mm	P/N:	DR: Stanley
1:1		A12x-M1xxCPF	CH: NJCJL
UNLESS OTHERWISE SPECIFIED TOLERANCES: X ±0.25 XX ±0.1 XXX ±0.05 ANGLE ±1°X		DWG.NO:	AP:
REV. A	SHEET 2/2	A12x-M1xxCPF	