

REV.	DESCRIPTION	DATE
A	ISSUE	Sep/15/2011

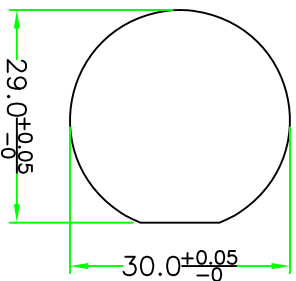

RECOMMENDED
PANEL CUT OFF

RoHS
IP67

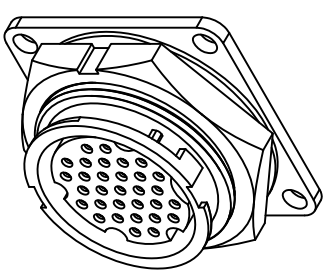
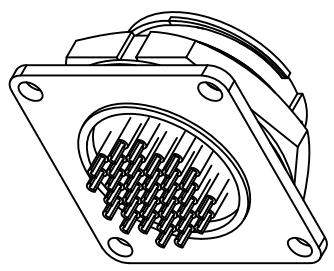
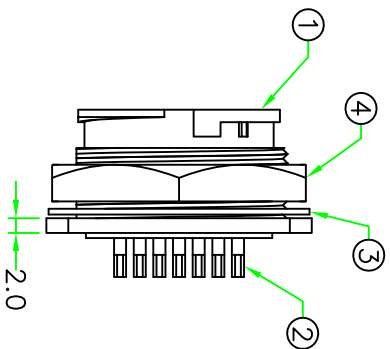
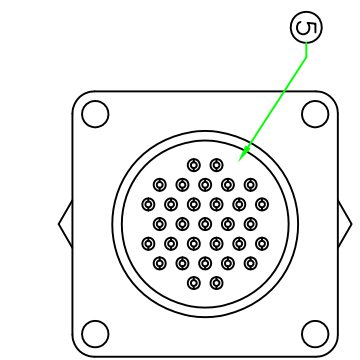
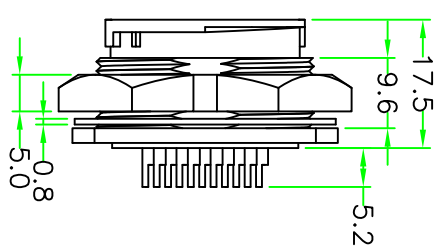
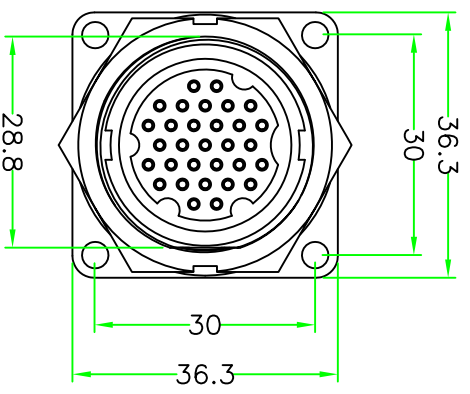

- NOTES:
- ELECTRICAL CHARACTERISTICS:
CURRENT RATING: 5A
CONNECTOR TEMPERATURE RANGE: -40°C TO +105°C
DIELECTRIC WITHSTANDING VOLTAGE:
500V AC FOR ONE MINUTE
 - HOW TO ORDER: CED-L331QS
31 - 31PIN
D - CURRENT RATING 5A

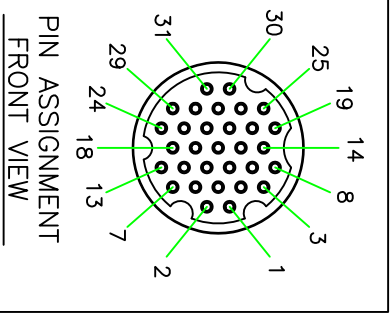

No.	PART NAME	DESCRIPTION	COLOR	QTY	REMARKS
5	GLUE	Glue.	BLACK	1	
4	HEX NUT	BRASS, Nickel Plated.		1	CEAPHNUT (36-135-N1)
3	GASKET	EPDM.	BLACK	1	C16-G
2	CONTACT	BRASS, 6u" Gold Plated, Solder Cup.		31	M12E-1.0SPL20.5
1	CONNECTOR	Circular E Size Connector Insert, NYLON+GF.	BLACK	1	CED-L331 82-135-N3

HOLIN® HTP ASIA TECHNOLOGY CO., LTD.
禾凌科技股份有限公司

TITLE : Circular E Size Male Connector Female Pin
Lock Type Square Flange Solder pin
All Plastic 31 Pin Panel connector

SCALE	UNIT: mm	1:1
UNLESS OTHERWISE SPECIFIED TOLERANCES:		
X ± 0.25	XX ± 0.1	
XXX ± 0.05	ANGLE ± 1°	
REV. SHEET		
A	1/1	
DWG.NO:	CED-L331QS	
DR. Jack		
CH. Sra.veey		
AP.		

REV.	DESCRIPTION	DATE
A	ISSUE	Dec/01/2011
A1	Correct dimension.	Dec/07/2011

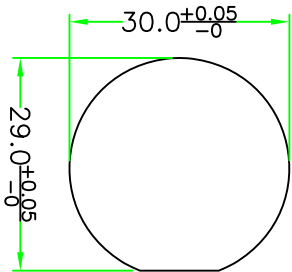

RECOMMENDED
PANEL CUT OFF

RoHS
IP67

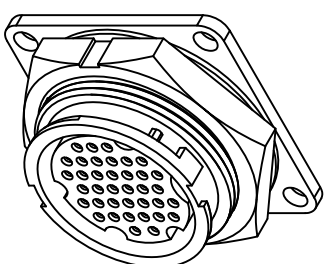
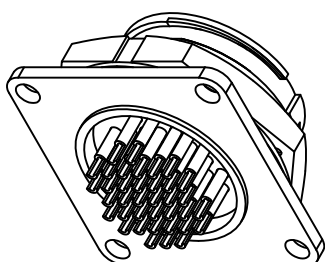
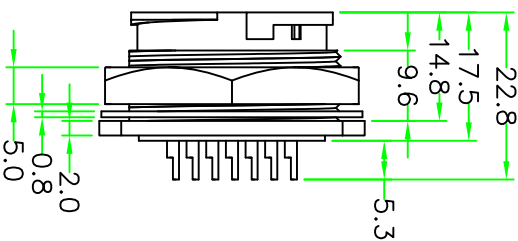

- NOTES:
- ELECTRICAL CHARACTERISTICS:
CURRENT RATING: 2A
CONNECTOR TEMPERATURE RANGE: -40°C TO +105°C
DIELECTRIC WITHSTANDING VOLTAGE:
500V AC FOR ONE MINUTE
 - HOW TO ORDER: CEN-L-337QS
37 - 37PIN
N - CURRENT RATING 2A

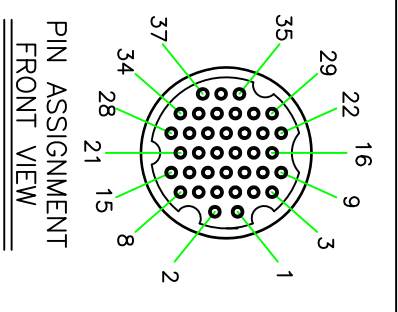
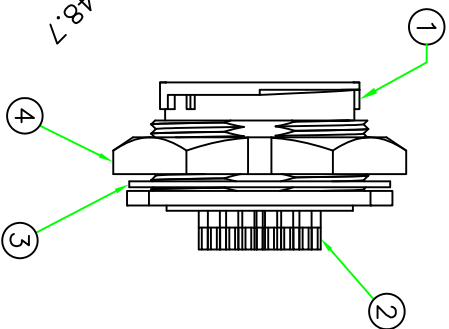
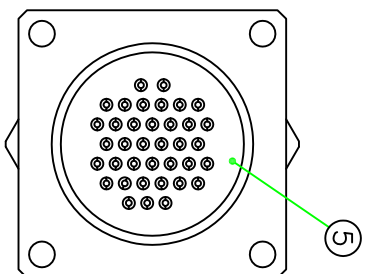
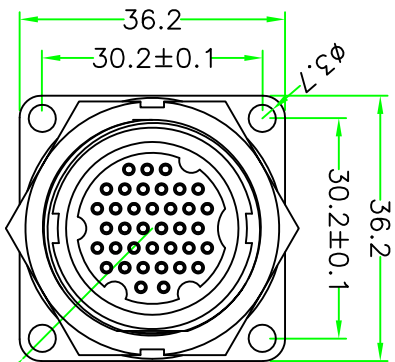

PIN ASSIGNMENT
FRONT VIEW

No.	PART NAME	DESCRIPTION	COLOR	QTY	REMARKS
5	Glue	Glue.	BLACK	1	
4	Hex Nut	Nylon+GF.	BLACK	1	CEAPHNUT (36-135-N1)
3	Gasket	EPDM.	BLACK	1	C16-G
2	Contact	BRASS, 6u" Gold Plated, Solder Cup.		37	M12E-1.0SPL20.5
1	Connector Insert	Nylon+GF.	BLACK	1	CEN-L337C (82-135-N3-1)

HOLIN® HTP ASIA TECHNOLOGY CO., LTD.
禾凌科技股份有限公司

TITLE : Circular E Size 37P Male Connector Female Pin
Lock type Square Flange Solder Bucket
All Plastic Panel Mount Connector

SCALE: 1:1
UNIT: mm
UNLESS OTHERWISE SPECIFIED TOLERANCES:
X ±0.25 XX ±0.1
XXX ±0.05 ANGLE ±1°X
REV. SHEET 1/1
P/N: CEN-L337QS
CH: strawney
DR: Jack
AP:

DWG.NO: CEN-L337QS