

PROPRIETARY AND CONFIDENTIAL  
 THE INFORMATION CONTAINED IN THIS DRAWING IS THE SOLE PROPERTY OF HTP ASIA TECHNOLOGY CO., LTD. .  
 ANY REPRODUCTION IN PART OR AS A WHOLE WITHOUT THE WRITTEN PERMISSION OF HTP ASIA TECHNOLOGY CO., LTD. IS PROHIBITED.

RoHS

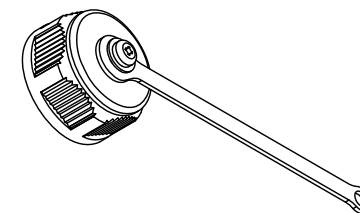
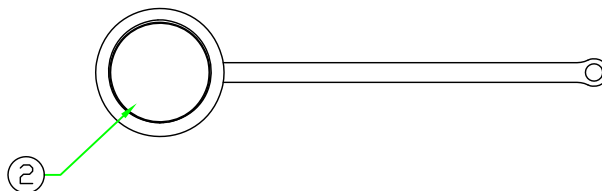
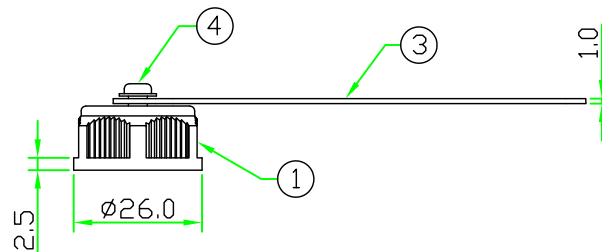
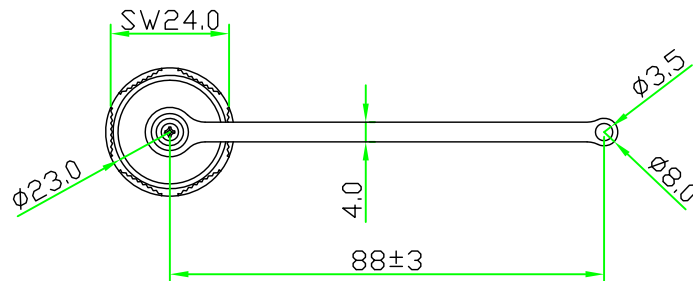
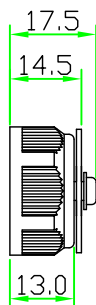
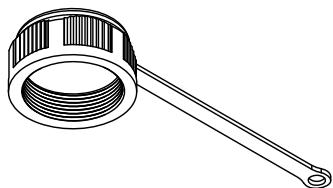

REV.	DESCRIPTION	DATE
A	ISSUE	Aug/15/2014

NOTE:  
 Maximum panel thickness:(mm)  
 (適用面板最大厚度)

Connector Type	With Waterproof Cap
C SIZE-SCREW	1.9
C SIZE-LOCK	1.9
HDMI-SCREW	3.9
RJ45-SCREW	4.0
RJ45-LOCK	4.0
USB-SCREW	3.9
USB-LOCK	4.0

OLD P/N:CCRJUSBP-WCAP-MC  
 (原型號)

No.	PART NAME	DESCRIPTION	COLOR	Q'TY	REMARKS
4	SCREW	STAINLESS STEEL.	BLACK	1	
3	CHAIN	RUBBER.	BLACK	1	
2	GASKET	RUBBER.	BLACK	1	
1	SCREW CAP	NYLON+GF.	BLACK	1	

**HOLIN**® HTP ASIA TECHNOLOGY CO., LTD.  
 禾凌科技股份有限公司

	UNIT: mm	TITLE :	Waterproof Cap Screw Type With Plastic Chain For C SIZE ,RJ45 ,HDMI ,USB Panel Connector
SCALE	1:1.5	P/N:	CCX-WCAP-MC
UNLESS OTHERWISE SPECIFIED TOLERANCES: .x ± 0.25 .xx ± 0.1 .xxx± 0.05 ANGLE ± 1'	REV.	SHEET	DR. Patty CH. ERIC
A	1/1	DWG.NO:	CCX-WCAP-MC AP.