

RECOMMENDED
PANEL CUT-OUT

RoHS

IP66~68

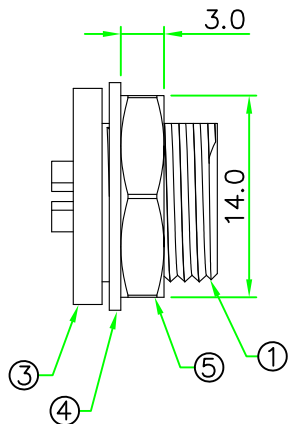
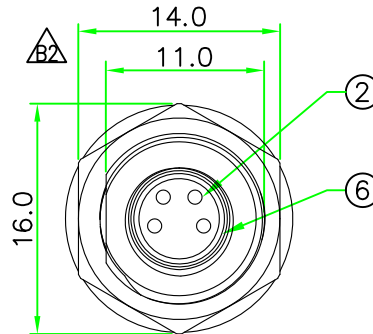
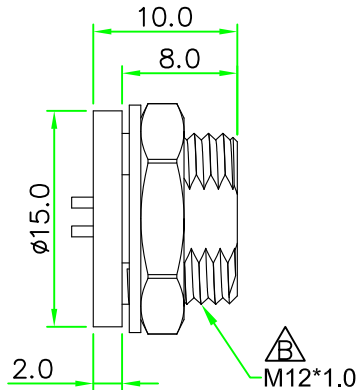

REV.	DESCRIPTION	DATE
A	ISSUE	Feb/18/2011
B	Modify the flat side.	Sep/02/2013
B1	Change P/N No.	Jul/03/2014
B2	Change diagram direction	Apr/22/2015
B3	Add 7-8 Pin & Correct Pin Assignment.	Oct/24/2018

NOTES:

1. ELECTRICAL CHARACTERISTICS:

CURRENT RATING: 1.5A / 3A

TEMPERATURE RANGE: -25°C TO +85°C

DIELECTRIC WITHSTANDING VOLTAGE:

500V AC FOR ONE MINUTE

2. HOW TO ORDER: A08x-M2xxCSR-S12



- 02 - 2 PINS 06 - 6 PINS
- 03 - 3 PINS 07 - 7 PINS
- 04 - 4 PINS 08 - 8 PINS
- 05 - 5 PINS

- I - CURRENT RATING 1.5A
- D - CURRENT RATING 3A

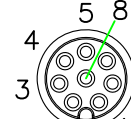
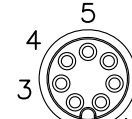
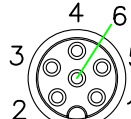
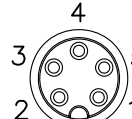
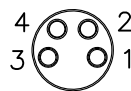
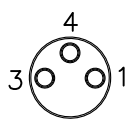

A08D-M202CSR-S12 A08D-M203CSR-S12 A08D-M204CSR-S12 A08I-M205CSR-S12 A08I-M206CSR-S12 A08I-M207CSR-S12 A08I-M208CSR-S12

PIN ASSIGNMENT FRONT VIEW (前視圖)

No.	PART NAME	DESCRIPTION	COLOR	Q'TY	REMARKS
6	O-RING	Viton.	BLACK	1	
5	HEX NUT	Brass ,Nickel Plated.		1	
4	GASKET	EPDM	BLACK	1	
3	HOUSING	Brass ,Nickel Plated.		1	
2	CONTACT	Brass ,Female Pin. 6u" Gold Plated.		N	
1	CONNECTOR	M8 A-Coding Female Connector Insert, Nylon+GF.	BLACK	1	

HOLIN® HTP ASIA TECHNOLOGY CO., LTD.
禾凌科技股份有限公司

	UNIT: mm	TITLE : M8 A-Coding Female Panel Connector Rear mount Circular Flange With Solder Bucket Pin	DR. SIBYL
SCALE 2:1			CH. ERIC
UNLESS OTHERWISE SPECIFIED TOLERANCES: .x ± 0.25 .xx ± 0.1 .xxx ± 0.05 ANGLE ± 1°	P/N: A08x-M2xxCSR-S12		
REV. B3	SHEET 1/1	DWG.NO: A08x-M2xxCSR-S12	AP.

REV.	DESCRIPTION	DATE
A	ISSUE	Arp/17/2018

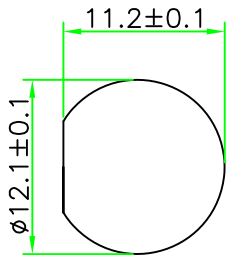

RECOMMENDED
PANEL CUT-OUT

RoHS
IP66~68

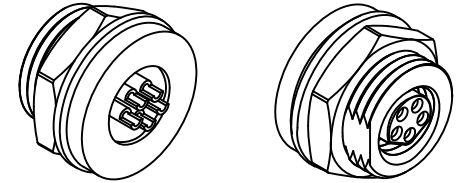
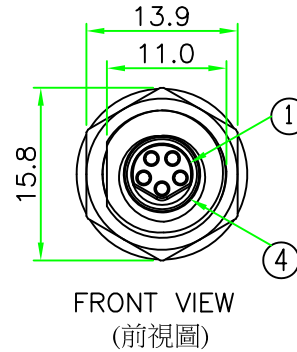
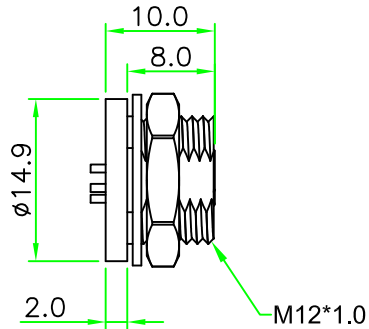
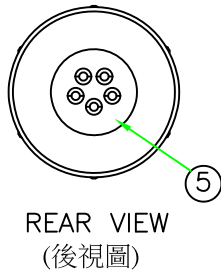

NOTES:
1. ELECTRICAL CHARACTERISTICS:
CURRENT RATING: 3A
TEMPERATURE RANGE: -25°C TO +85°C
DIELECTRIC WITHSTANDING VOLTAGE:
500V AC FOR ONE MINUTE
2.PANEL THICKNESS MAX. 4.0mm

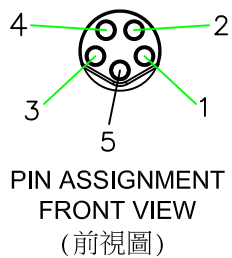
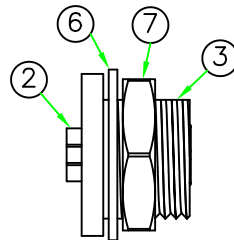

7	HEX NUT	Brass ,Nickel Plated.		1	
6	GASKET	EPDM	BLACK	1	
5	GLUE	EPOXY.	BLACK	1	
4	O-RING	VITON	BLACK	1	
3	HOUSING	Brass, Nickel Plated.		1	
2	CONTACT	Brass, 6 u" Gold plated. Female Contact.		5	
1	CONNECTOR	M8 B-Coding Female Connector Insert, NYLON+GF.	BLACK	1	12-135
No.	PART NAME	DESCRIPTION	COLOR	Q'TY	REMARKS

HOLIN® HTP ASIA TECHNOLOGY CO., LTD. 禾凌科技股份有限公司					
		UNIT:mm	TITLE : M8 B-Coding Female Panel Connector Rear mount Circular Flange With Solder Bucket Pin		
SCALE	1.5:1	P/N: B08D-M205CSR-S12			DR. SIBYL
UNLESS OTHERWISE SPECIFIED TOLERANCES:		.x ± 0.25 .xx ± 0.1			CH. ERIC
		.xxx± 0.05 ANGLE ± 1°			
REV.	SHEET	DWG.NO:	AP.		
A	1/1	B08D-M205CSR-S12			