

RoHS Compliant

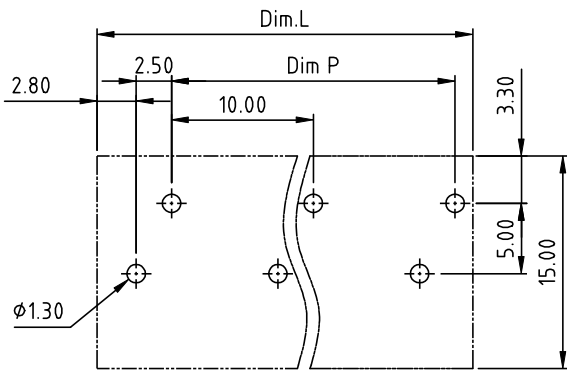

Rev.	SIGN	DATE	DESCRIPTION	APPROVER
C	△	08/13'12	structure design is changed	Dacheng
D	△	08/25'12	Changed from 250°C±10°/5 Sec to 260°C±5°C/5 Sec	Dacheng
E	△	11/18'19	Add the Rohs Compliant & Amphenol Logo.	Guoxue
	△	11/18'19	Add the cULus logo& Color Code.	Guoxue
	△	11/18'19	Add the "Reference dimension"	Guoxue
	△	11/18'19	Add the "Wave Soldering temperature: 260°C ±5°C/5 Sec"	Guoxue
	△	11/18'19	Delete the "Dim.P"	Guoxue
△	11/18'19	Add the lever color.	Guoxue	

THIS IS CAD DRAWING, DO NOT REVISE MANUALLY!!!

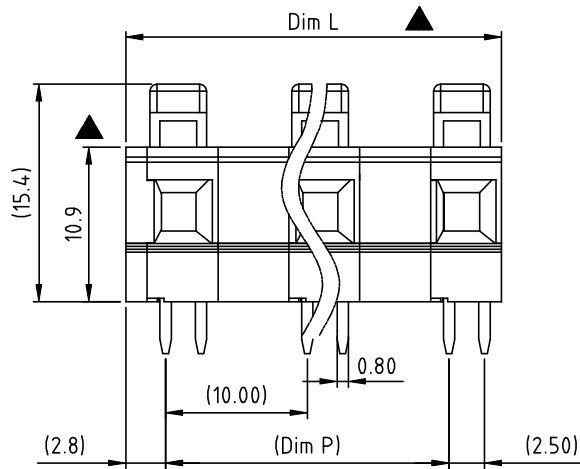
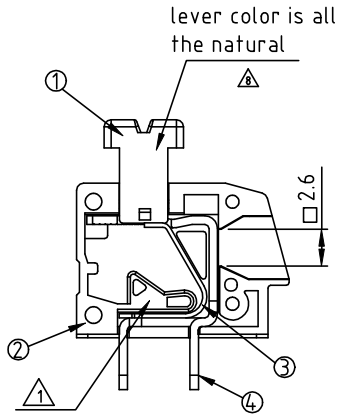
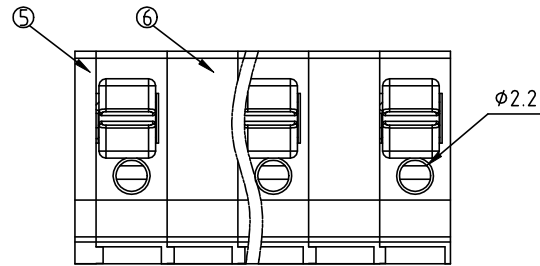

PCB Layout TOP VIEW

N = Number of poles  
 Dim L = (N-1) × 10.0 + 6.5  
 Dim P = (N-1) × 10.0

	Dim L
2-6p	±0.25
7-12p	±0.40

- Material:
- Item ① Terminal lever: Thermoplastic (UL94V-0)
  - Item ② Terminal housing: Thermoplastic (UL94V-0)
  - Item ③ Spring clamp: Stainless steel
  - Item ④ Solder pin: Brass, Tin plated
  - Item ⑤ Terminal cover: Thermoplastic (UL94V-0)
  - Item ⑥ Terminal pad board : Thermoplastic (UL94V-0)

- Electrical: cULus
- Voltage rating: 300 V
  - Current rating: 11 A
  - Wire range:
  - Solid wire(AWG): 12-20
  - Stranded wire(AWG): 12-20
  - Wire strip length: 10-11 mm
  - Withstanding Voltage: 1.6KV
  - Operating temperature: -40°C to +115°C

- △ Wave Soldering temperature: 260°C ±5°C/5 Sec
- Safety Approval: cULus △
- Critical dimension: ▲
- △ Reference dimension: ( × ) The dimensions of pitch are just for reference, take the actual assembly result as a judgment when inserting the terminal block into the PCB hole.

H6 xx 2 0 x 0 xxxx G

No. OF POLES  
 02: 2 POLES  
 :  
 12: 12 POLES

△ COLOR

- 0 Black (RAL9005)
- 2 Red (RAL3001/D)
- 3 Orange (RAL2011/P)
- 4 Yellow (RAL1018/A)
- 5 Green (RAL6018/T)
- 6 Blue (RAL5015/A)
- 8 Grey (RAL7035/D)
- 9 White (RAL1102)
- C Green (RAL6018/U)

G: RoHS compliant (lead<4%) In copper Alloy  
 1000: "@ " Logo (Standard)  
 100A: "ANYTEK" Mark  
 Any special item by customer request, please contact sales department.

<b>Amphenol ANYTEK</b>				<b>CUSTOMER COPY</b>	
ALL RIGHTS RESERVED. REPRODUCTION OR ISSUE TO THIRD PARTIES IN ANY FORM WHATSOEVER IS NOT PERMITTED WITHOUT WRITTEN AUTHORITY FROM THE PROPRIETOR. PROPERTY OF ANYTEK TECHNOLOGY CO., LTD					
TITLE		H6 10.0mm Series ( Square hole )			
PART NO.		H6xx20x0xxxxG		DWG NO. 8H60305	
APPROVED	CHECKED	DESIGNED	DRAWN	CUST NO.	
		Guoxue 2019.11.18	Guoxue 2019.11.18		
				Tolerance X. ±0.50 X.X ±0.30 X.XX ±0.10 X° ±1°	
				UNIT: mm SCALE: NONE SHEET: 01/01 REV.: E	